

DPX-4010 DPX-4010/PH4

SERVICE MANUAL

Sub panel
(A22-2880-08)

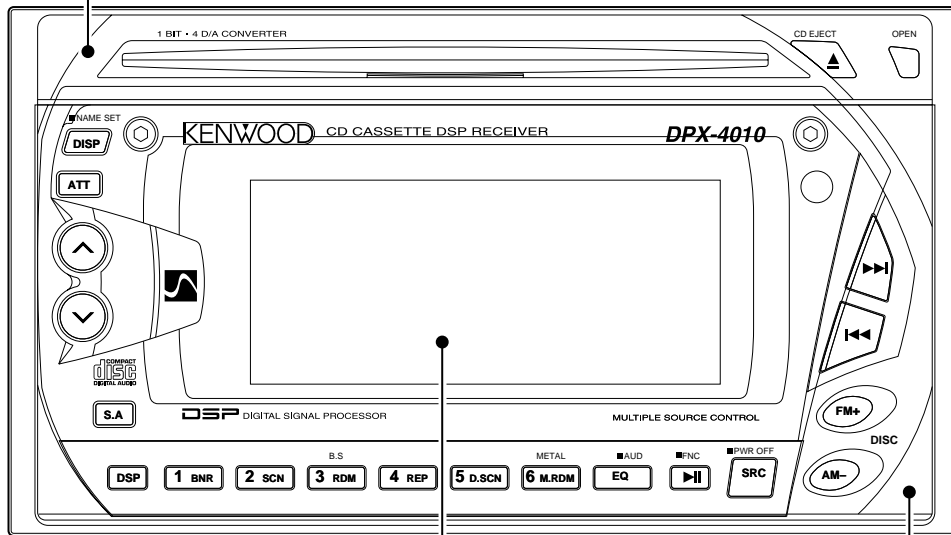

Front glass assy
(B10-4041-08) : K type or M type
(B10-4043-08) : PH4 type

Front panel assy
(A64-2284-08) : K type
(A64-2285-08) : M type or PH4 type

DC cord assy
(E30-4860-08)

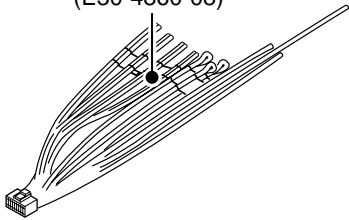

Remote controller assy
(A70-0883-05)

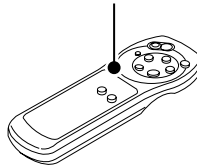

Size AAA battery
(Not supplied)

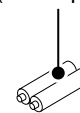

Screw set
(N99-1671-08)

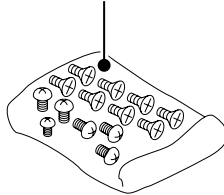

HONDA attach kit
(J21-9578-05) : K type or M type
(J21-9617-05) : PH4 type

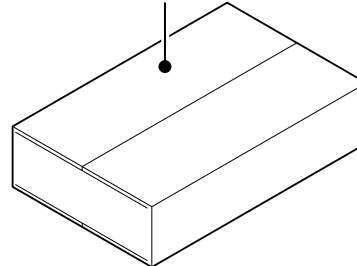

- DPX-4010/PH4 is philippines HONDA genuine model.
- CD mechanism operation description is please refer to the service manual KDC-5007/5008 (B51-7090-00).
- Cassette mechanism operation description is please refer to the service manual D40-1122-05 (B51-7452-00).



DPX-4010,4010/PH4

BLOCK DIAGRAM

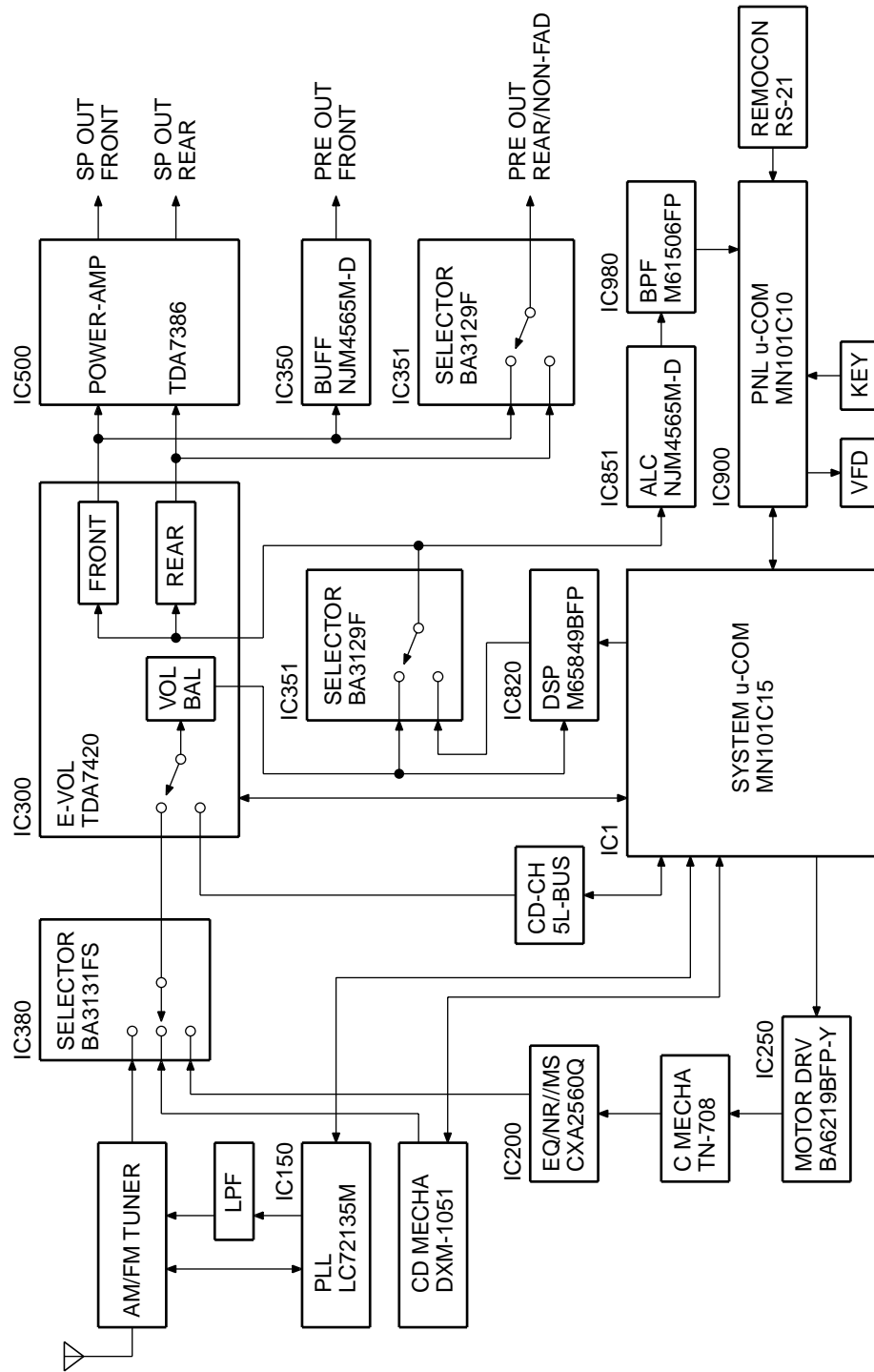

MICROCOMPUTER'S TERMINAL DESCRIPTION

System Microcomputer MS101C15FCJ (IC1: Main PWB Unit)

Pin No.	Pin Name	Signal Name	I/O	Purpose/Description	Normal Operation Level
1	VREF (-)			Connected to GND	
2	PA0/AN0	CD_EJ	I	CD/EJ_SW detection terminal [H: Normal. L: Eject]	L (a)
3	PA1/AN1	TYPE	I	Destination type selection input [H: J Type. M: K Type. L: M Type]	-
4	PA2/AN2	REEL_S	I	REV reel pulse detection terminal	H/L
5	PA3/AN3	REEL_T	I	FWD reel pulse detection terminal	H/L
6	PA4/AN4	AM_SD	I	AM SD input [H: Station detected. L: Station not detected]	H (a)
7	PA5/AN5	FM_SA	I	FM SD input [H: Station detected. L: Station not detected]	H (a)
8	PA6/AN6/	NC	I		-
9	PA7/AN7	SMALL	I	SMALL detection input [H: SMALL off. L: SMALL on]	L (a)
10	VREF (+)			Connected to BU 5 V	
11	Vdd			Connected to Vdd	
12	OSC2	X'Tal (8.38)		X'tal (connected to 8.38 MHz)	
13	OSC1	X'Tal (8.38)		X'tal (connected to 8.38 MHz)	
14	Vss			Connected to GND	
15	XI			Connected to GND	
16	XO			Open	
17	MMOD			Connected to GND	
18	P00/SBO0/TXD	C_MAIN_M	O	C-mechanism motor control [H: ON. L: OFF]	H (a)
19	P01/SBI0/RXD	INPUT_SEL1	O	E_VOL input switching control (in combination with pin 20)	H/L
20	P02/SBT0	INPUT_SEL2	O	[HL: CD. LH: Tape. LL: Tuner]	H/L
21	P03/SBO1	CH_DATAH	O	Data output to CD-CH	H/L
22	P04/SBI1	CH_DATA_C	I	Data input from CD-CH	H/L
23	P05/SBT1	CH_CHCLK	I/O	Previous bus: Data input from CD-CH. New bus: Data output to CD-CH.	H/L
24	P06/BUZZER/DK	BEEP	O	Beep output [Permanently L]	L
25	P27/RESET	RESET	I	System reset [H: Operation. L: Reset]	L (a)
26	P10/TM010/RMOUT	CH_REQH	O	Send request output to CD-CH	L (a)
27	P11/TM1IO	CH_CHCON	O	CD-CH operation control	H (a)
28	P12/TM2IO	CH_CH1/2	O	CD-CH 1/2 switching output	
29	P13/TM3IO	PNL_OPEN	I	Panel open detection [H: Closed. L: Open]	L (a)
30	P14/TM4IO	TP	O	Test point (Valid only in test mode). [Permanently L]	L
31	P20/IRQ0	BU_DET	I	Back_Up detection input [H: Power down. L: Normal]	H (a)
32	P21/IRQ1/SENS	CH_REQ_C	I	Send request input from CD-CH	L (a)
33	P22/IRQ2	PN_SC_REQ	I	Send request input from PNL_μCOM	H (a)
34	P23/IRQ3	TYPE2	I	Destination type selection input (for genuine model)	-
35	P24/IRQ4	ACC_DET	I	Acc detection input [H: Acc OFF. L: Acc ON]	H (a)
36	P30/SBO2	CD_DATA	I/O	Data input/output from/to CD mechanism	H/L
37	P31/SBI2	NC	I	Not used (Open)	-
38	P32/SBT2	CD_CDK	O	CLK output to CD mechanism	H/L
39	P33/BR	C_SUB_M+	O	C-mechanism loading motor control	H (a)
40	P34/BT	C_SUB_M-	O	C-mechanism loading motor control	H (a)
41	P35/LDDMA	C_MSC	O	Blank detection mode control [H: G2 (in play mode). L: G1 (in FF mode)]	H/L
42	P36/STDMA	C_NR	O	Dolby ON/OFF control	H (a)
43	P37/DKDMA	C_MS_IN	I	Blank pulse detection input	H/L
44	P40/KEY0	C_MTL	O	Metal ON/OFF control.	H (a)
45	P41/KEY1	C_MODE2	I	Sub-motor control terminal 2	H/L
46	P42/KEY2	C_MODE3	I	Sub-motor control terminal 3 (cassette pack IN detection terminal)	H/L
47	P43/KEY3	C_MODE1	I	Sub-motor control terminal 1	H/L
48	P44/KEY4	DSP_DATA	O	DATA output to DSP	H/L
49	P45/KEY5	DSP_CLK	O	CLK output to DSP	H/L
50	P46/KEY6	DSP_STB	O	LATCH output to DSP	H/L

DPX-4010,4010/PH4

MICROCOMPUTER'S TERMINAL DESCRIPTION

Pin No.	Pin Name	Signal Name	I/O	Purpose/Description	Normal Operation Level
51	P47/KEY7	N-F_MUTE	O	Muting of N-F when N-F is selected [H: Muting. L: Normal]	H (a)
52	P50/WE	AUDIO1	O	LINE OUT switching [H: FRONT. L: REAR]	H (a)
53	P51/RE	DSP_CONT	O	DSP ON/OFF control [L: DSP OFF (bypass). H: DSP ON]	H (a)
54	P52/CS	MUTE	O	AUDIO_MUTE output [H: Muting ON. L: Muting OFF]	H (a)
55	P53/A16	P_ON	O	Internal power control [H: ON. L: OFF]	H (a)
56	P54/A17	P_CON	O	External power control [H: ON. L: OFF]	H (a)
57	P60/A0	EVOL_DATA	I/O	DATA input/output from/to E_VOL (TDA7400)	H/L
58	P61/A1	EVOL_CLK	O	CLK output to E_VOL (TDA7400)	H/L
59	P62/A2	CD_SW1	I	Input from CDSW1 (Loading start SW)	L (a)
60	P63/A3	CD_SW2	I	Input from CDSW2 (12 cm disc detection SW)	L (a)
61	P64/A4	CD_SW3	I	Input from CDSW3 (Down & limit SW)	L (a)
62	P65/A5	CD_LO/EJ	I/O	CD mechanism loading motor control (LO/EJ) [H: Load. L: Eject]	H (a)
63	P66/A6	CD_LMON	O	CD mechanism loading motor control (ON/OFF) [H: Stop. L: Operate]	H (a)
64	P67/A7	C_F/R	O	Head switching control [H: Reverse. L: Forward]	H/L
65	P70/A8	CD_MSTOP	O	CD mechanism emergency stop output	L (a)
66	P71/A9	CD_MRST	O	CD mechanism reset output	L (a)
67	P72/A10	CD_MUTE	I	Muting input from CD mechanism	L (a)
68	P73/A11	P_ANT	O	POWER_ANT control [H: Radio mode. L: Other mode]	H (a)
69	P74/A12	PLL_CE	O	CE selection to LC72135M	H (a)
70	P75/A13	PLL_DO	O	DATA output to LC72135M	H/L
71	P76/A14	PLL_CLK	O	CLK output to LC72135M	H/L
72	P77/A15	PLL_CI	I	DATA input from LC72135M	H/L
73	P87/LED7/D7	SW40	O	VFD_Vdd2 control [H: Vdd2 ON. L: Vdd2 OFF]	H (a)
74	P86/LED6/D6	ILL_CON	O	Button illumination control [H: Illumination ON. L: Illumination OFF]	H (a)
75	P85/LED5/D5	PWIC_STBY	O	Power IC standby control [H: AMP ON. L: AMP OFF]	H (a)
76	P84/LED4/D4	PN_MC_REQ	O	Send request output to PNL_μCOM	H (a)
77	P83/LED3/D3	PN_SC_CON	O	Operation control output to PNL_μCOM	H (a)
78	P83/LED2/D2	PN_MC_DATA	O	DATA output to PNL_μCOM	H/L
79	P81/LED1/D1	PN_SC_DATA	I	DATA input from PNL_μCOM	H/L
80	P80/LED0/D0	PN_MC_CLK	O	CLK output to PNL_μCOM	H/L

Level: High level (active) →H (a), Low level (active) →L (a)

Panel Microcomputer MN101C10AAK (IC900: Combination PWB Unit)

Pin No.	Pin Name	Signal Name	I/O	Purpose/Description	Normal Operation Level
1~5		NC (GND)	I	Not used (GND)	L
6	VREF+	VREF+	I	A/D converter reference voltage input terminal	-
7	VDD	VDD	-	Positive power supply terminal	-
8	OSC2	OSC2	-	Main clock connection (8.38 MHz)	-
9	OSC1	OSC1	-	Main clock connection (8.38 MHz)	-
10	VSS	VSS	-	Connected to GND	-
11	XI	XI	I	Connected to GND	L
12	XO	XO	O	Not used (Open)	-
13	MMOD	MMOD	I	Connected to GND	L
14	P00/SBO0/TXD	PN_SC_DATA	O	System control communication, data output terminal	H/L
15	P01/SBI0/RXD	PN_MC_DATA	I	System control communication, data input terminal	H/L
16	P02/SBT0	PN_MC_CLK	I	System control communication, clock input terminal	H/L
17	P03/SBO1	VFD_DATA	O	VFD driver data output	H/L
18	P04/SBI1	NC	O	Not used (Open)	L
19	P05/SBT1	VFD_CLK	O	VFD driver clock output	H/L

MICROCOMPUTER'S TERMINAL DESCRIPTION

Pin No.	Pin Name	Signal Name	I/O	Purpose/Description	Normal Operation Level
20	P06/BUZ/DK	VFD_STB	O	VFD driver latch output	H/L
21	P27/RST	RST	I	Microcomputer reset	L (a)
22	P10/TM0IO/RMO	VFD_BLK	O	VFD driver blank output	L (a)
23-25		NC	O	Not used (Open)	L
26	P14/TM4IO	PN_SC_REQ	O	System control communication, send request output	H (a)
27	P20/IRQ0	PN_MC_REQ	I	System control communication, receive request input	H (a)
28	P21/IRQ/SENS	PN_SC_CON	I	System control communication, panel operation control	H (a)
29	P22/IRQ2	REMOCON	I	Remote control signal input	H/L
30	P23/IRQ3	KR0	I	Key return signal input 0	H/L
31	P24/IRQ4	KR1	I	Key return signal input 1	H/L
32	P50/WE	KR2	I	Key return signal input 2	H/L
33	P51/RE	KR3	I	Key return signal input 3	H/L
34	P52/CS	KR4	I	Key return signal input 4	H/L
35	P53/A16	NC	O	Not used (Open)	L
36	P54/A17	NC	O	Not used (Open)	L
37	P60/A0	KS0	O	Key scan signal output 0	H/L
38	P61/A1	KS1	O	Key scan signal output 1	H/L
39	P62/A2	KS2	O	Key scan signal output 2	H/L
40	P63/A3	KS3	O	Key scan signal output 3	H/L
41	P64/A4	KS4	O	Key scan signal output 4	H/L
42-56		NC	O	Not used (Open)	L
57	P83/D3/LED3	ENB	O	Peak hold IC output switching enable	H (a)
58	P82/D2/LED2	SEL_C	O	Peak hold IC output setting change	H (a)
59	P81/D1/LED1	SEL_B	O	Peak hold IC output setting change	H (a)
60	P80/D0/LED0	SEL_A	O	Peak hold IC output setting change	H (a)
61	VREF-	VREF-	I	Connected to GND	L
62	PA0/AN0	PH_IN	I	Peak hold input terminal	A
63,64		NC (GND)	I	Not used (GND)	L

Level: High level (active) →H (a), Low level (active) →L (a)

Key Matrix Table

	KS0	KS1	KS2	KS3	KS4
KR0	SRC	M1	M2	SA	PAUSE
KR1	CR-EJ	M3	M4	FM	
KR2		M5	M6	AM	
KR3	DSP	ATT	VOL (+)	TUN (+)	
KR4	EQ	DISP	VOL (-)	TUN (-)	

Line valid when OFF

* CD-EJ is detected by the System Controller.

Allocation of Multi-press Keys

Key Allocation	Function
While ALL OFF, DSP + EQ + SRC	Start the unit in test mode.
While ALL OFF, M1 + M5 + SRC	Span switching (Valid only with K and M Types) AM: [9K/10K]. FM: [50K/200K]

DPX-4010,4010/PH4

ADJUSTMENT

Set the controls and switches as follows.

BALANCE : Center position BASS : Center Position LOUD : OFF DOLBY NR : OFF
 FADER : Center position TREBLE : Center position METAL : OFF

No.	ITEM	INPUT SETTINGS	OUTPUT SETTING	TUNER (RECEIVER) SETTINGS	ALIGNMENT POINTS	ALIGN FOR	FIG.
FM SECTION							
1	DISCRIMINATOR	98.1MHz 0dev 60dB μ (ANT input)	Connect a DC voltmeter to TP F/E (TU100)	FM 98.1MHz	T F/E (TU100)	0V	(a)
CASSETTE DECK SECTION							
[1]	AZIMUTH (1/2)	MTT-902 Mirror Tape	—	—	Head Azimuth Screw	Playing the mirror tape in FWD mode, rotate screw (A) and (B) so as to eliminate a curl at the guides on both ends of head while looking into the mirror. Play the tape in REV mode. And make adjustment in the same manner.	(b)
[2]	AZIMUTH (2/2)	TCC-153 10kHz, -10dB	Connect a AC voltmeter and oscilloscope to pri out	PLAY	Head Azimuth Screw	Adjust the azimuth for each Lch/Rch or FWD/RVS becomes maximum.	(b)
[3]	PLAY BACK LEVEL	TCC-130	Connect a AC voltmeter to CN200	PLAY	VR200A (L) VR200B (R)	300mV	(c)

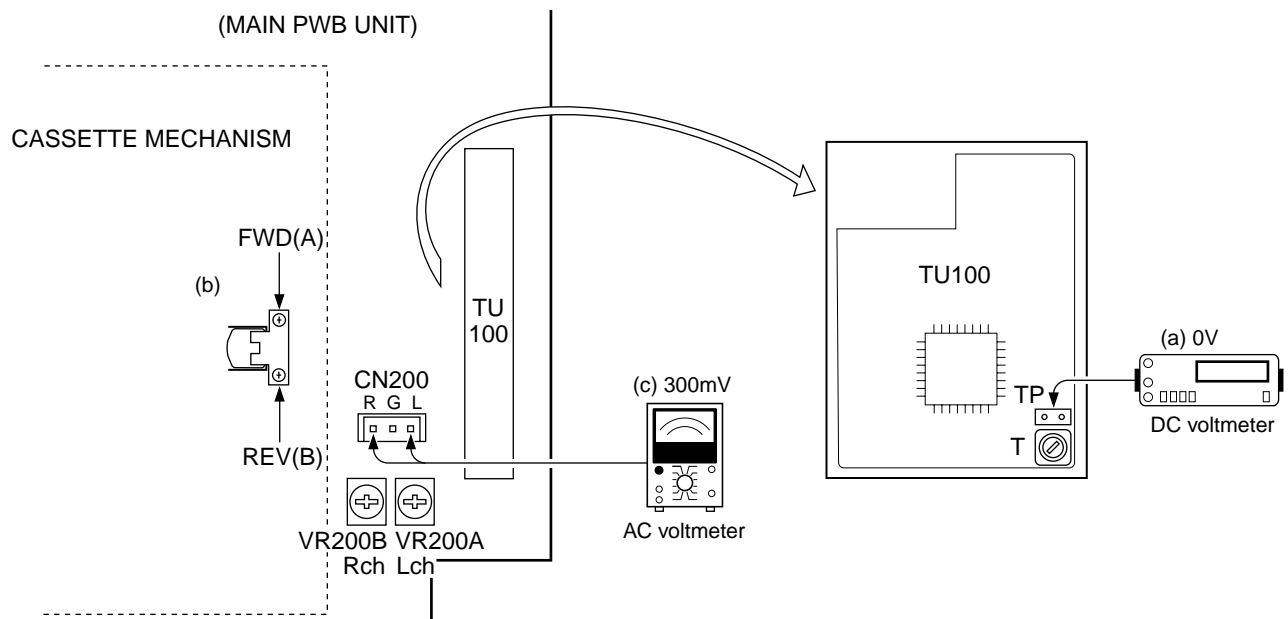

PC BOARD (COMPONENT SIDE VIEW)

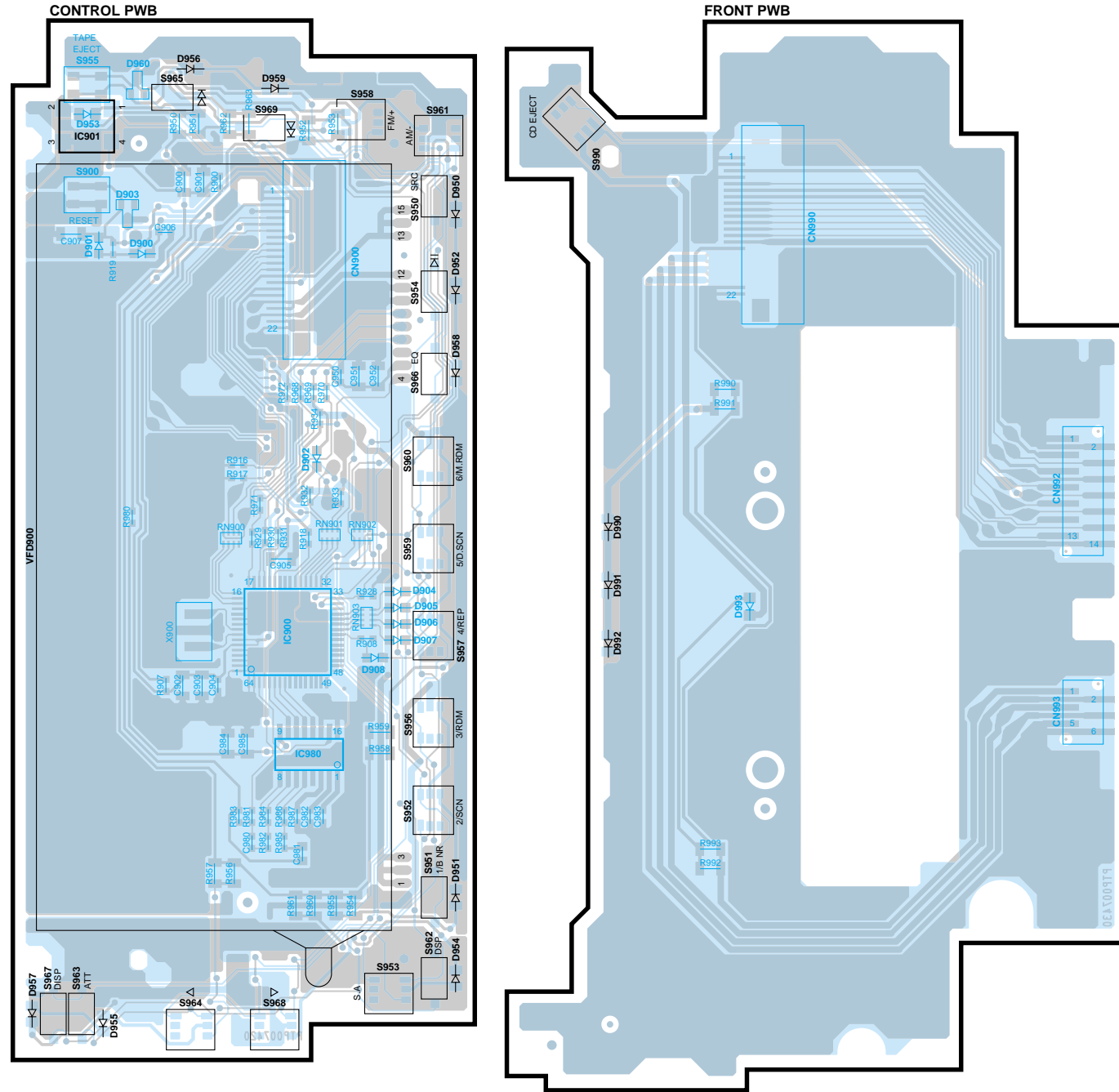

CONTROL

IC	Q	Address
900		4B
901		2A
980		4B

Refer to the schematic diagram for the values of resistors and capacitors.

(FOIL SIDE VIEW)

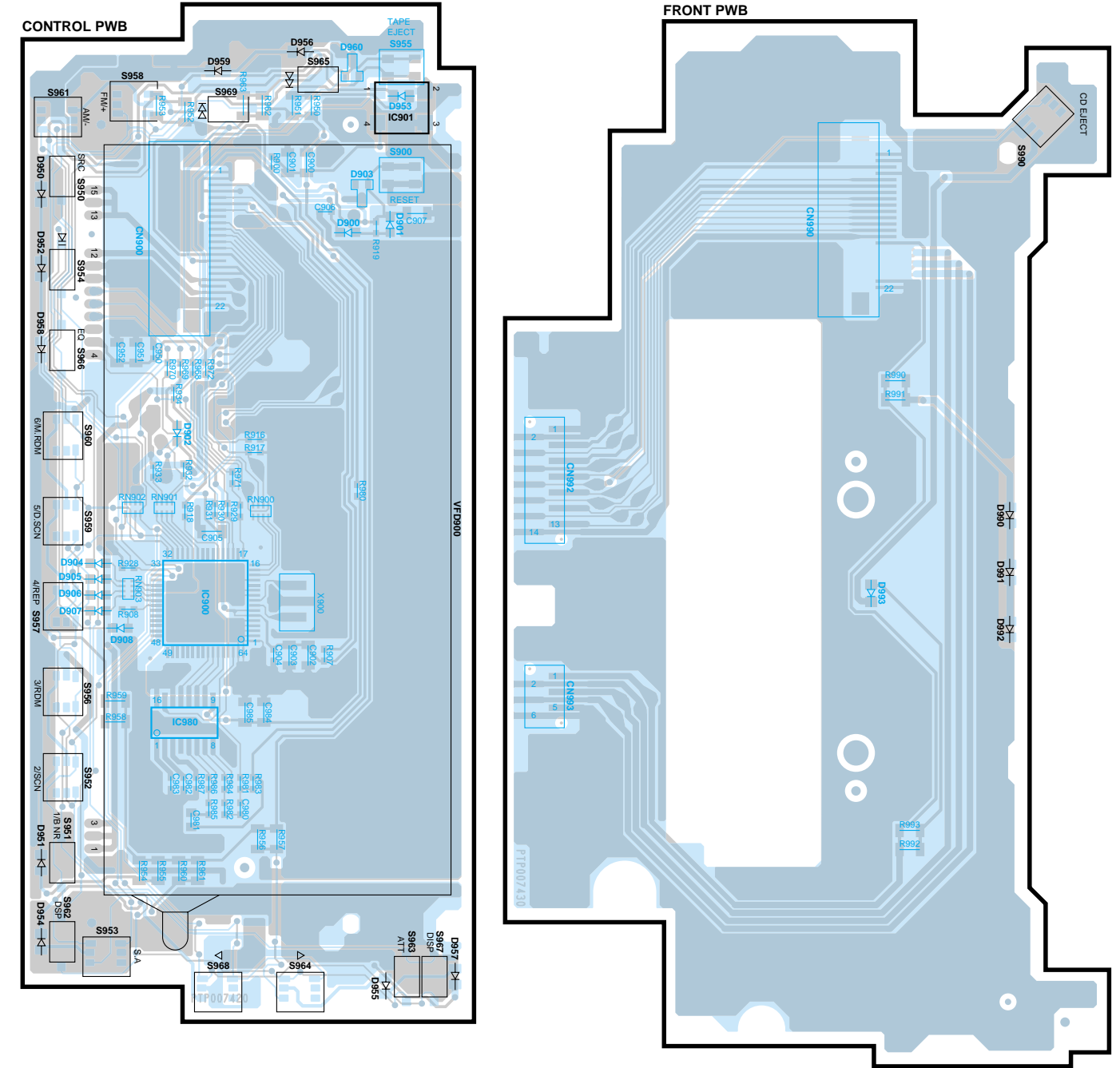

CONTROL

IC	Q	Address
900		4F
901		2G
980		4F

PC BOARD (FOIL SIDE VIEW)

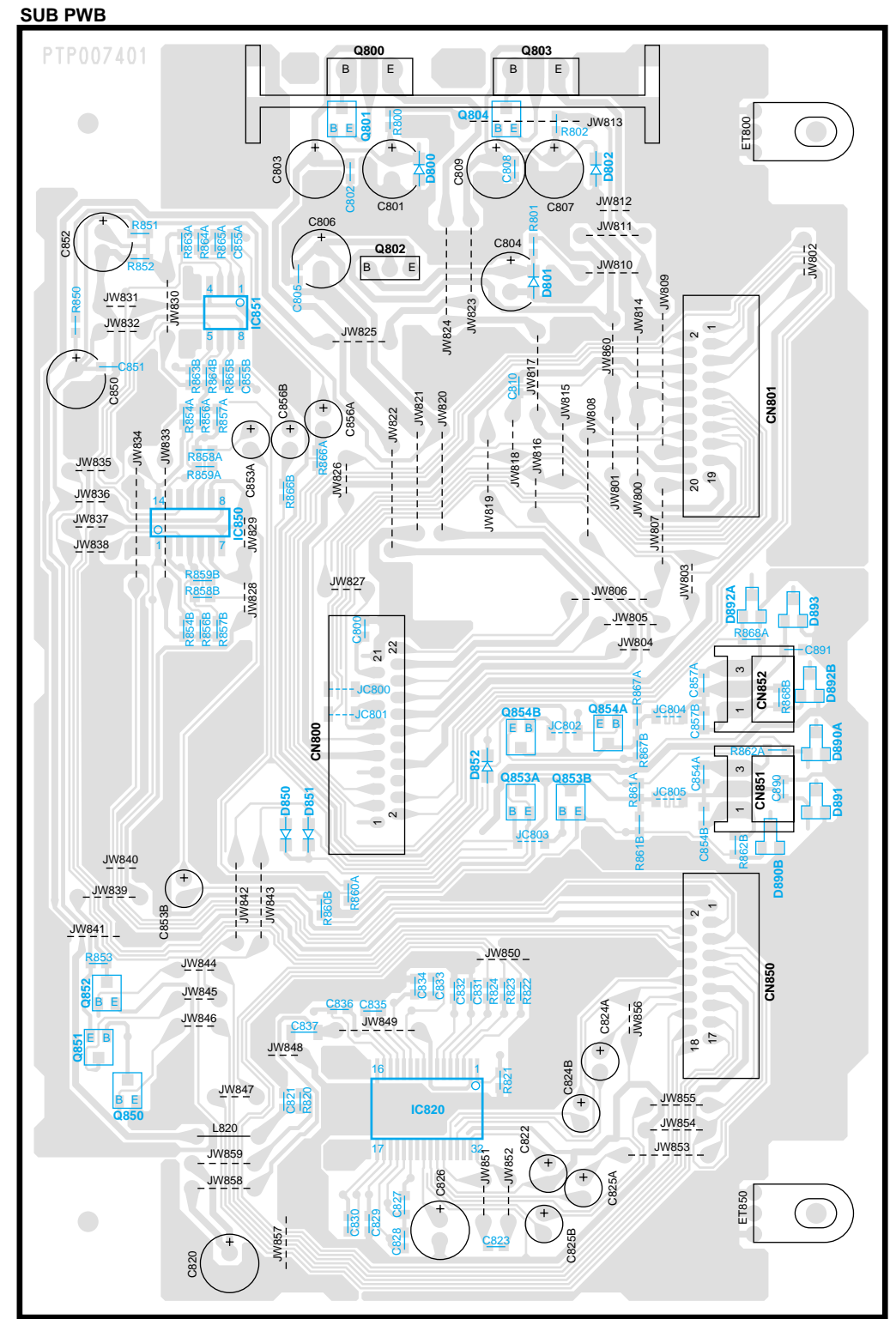
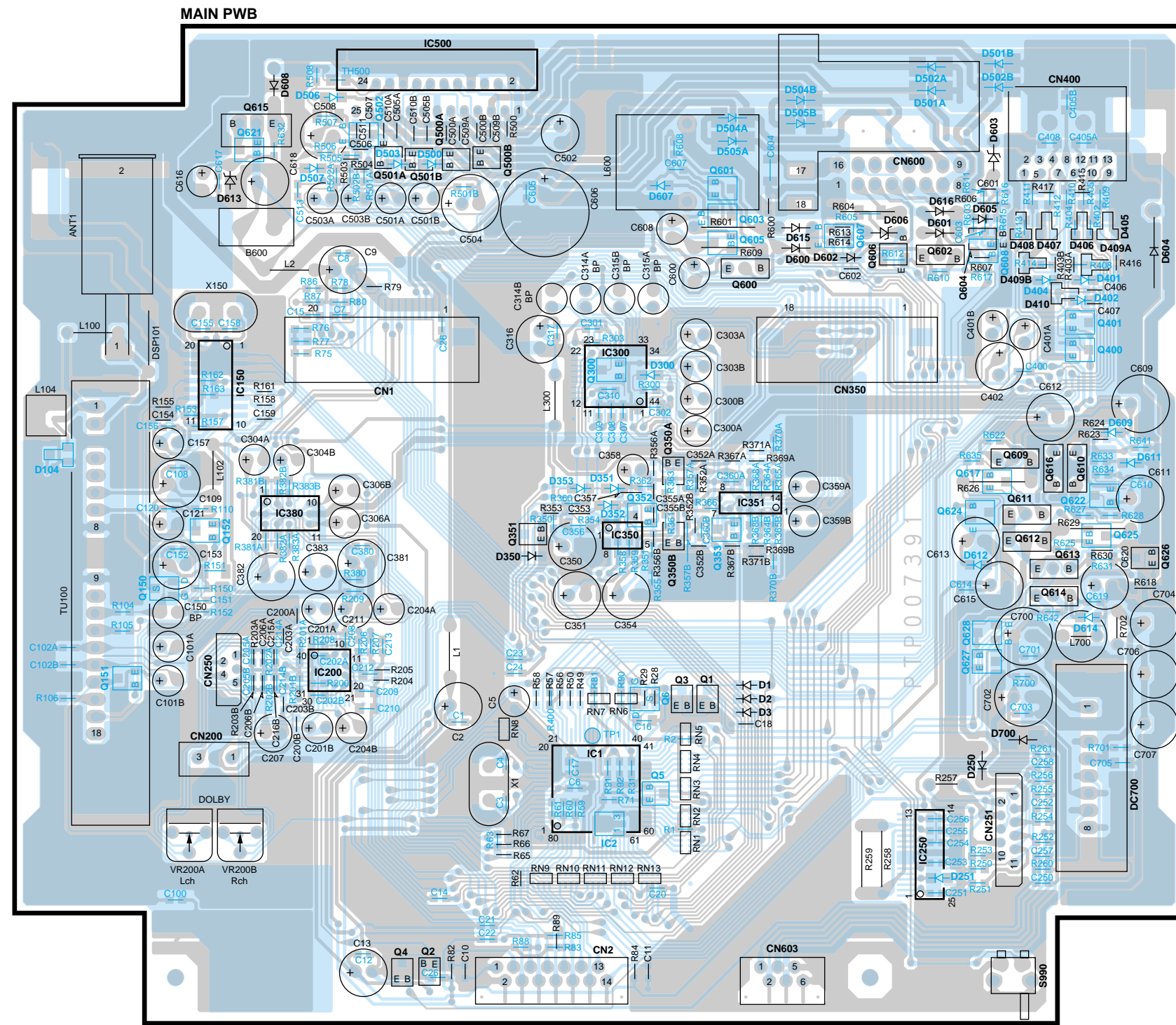

MAIN PWB

IC	Q	Address	IC	Q	Address	IC	Q	Address	IC	Q	Address	IC	Q	Address	IC	Q	Address
1		5X	380		4V	150		4V	400		3Z	603		2X	611		4Z
2		5X	500		2W	151		4U	401		3Z	604		2Z	612		4Z
150		3V		1	5X	152		4V	500		2W	605		2X	613		4Z
200		4V		2	6W	300		3X	501		2W	606		2Y	614		4Z
250		5Y		3	5X	350		4X	502		2W	607		2Y	615		2V
300		3X		4	6W	351		4W	600		3X	608		2Z	616		3Z
350		4X		5	5X	352		4X	601		2X	609		3Z	617		3Z
351		4X		6	5X	353		4X	602		2Y	610		3Z	621		2V

SUB PWB

IC	Q	Address	IC	Q	Address	IC	Q	Address	IC	Q	Address
820		6AB	801		2AB	850		5AA	854		4AC
850		3AB	802		2AB	851		5AA			
851		2AB	803		2AC	852		5AA			
800		2AB	804		2AC	853		4AC			

Refer to the schematic diagram for the values of resistors and capacitors.

PC BOARD (COMPONENT SIDE VIEW)

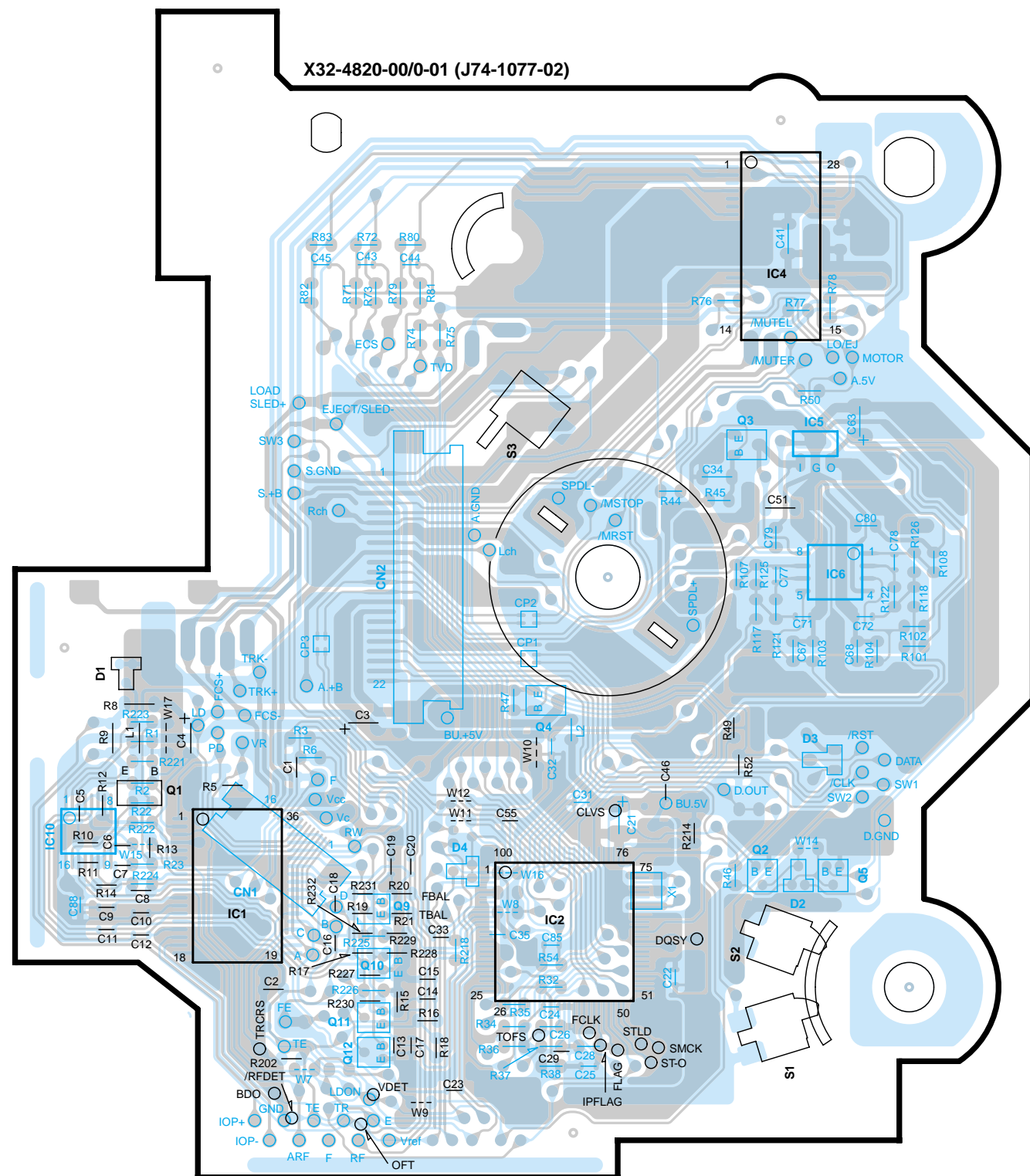

X32-4820-01

IC	Q	Address	IC	Q	Address	IC	Q	Address
1		5AF	10		5AE	5		5AM
2		5AG	1		5AE	9		5AF
4		2AM	2		5AM	10		5AF
5		3AM	3		3AM	11		6AF
6		4AM	4		4AG	12		6AF

Refer to the schematic diagram for the values of resistors and capacitors.

(FOIL SIDE VIEW)

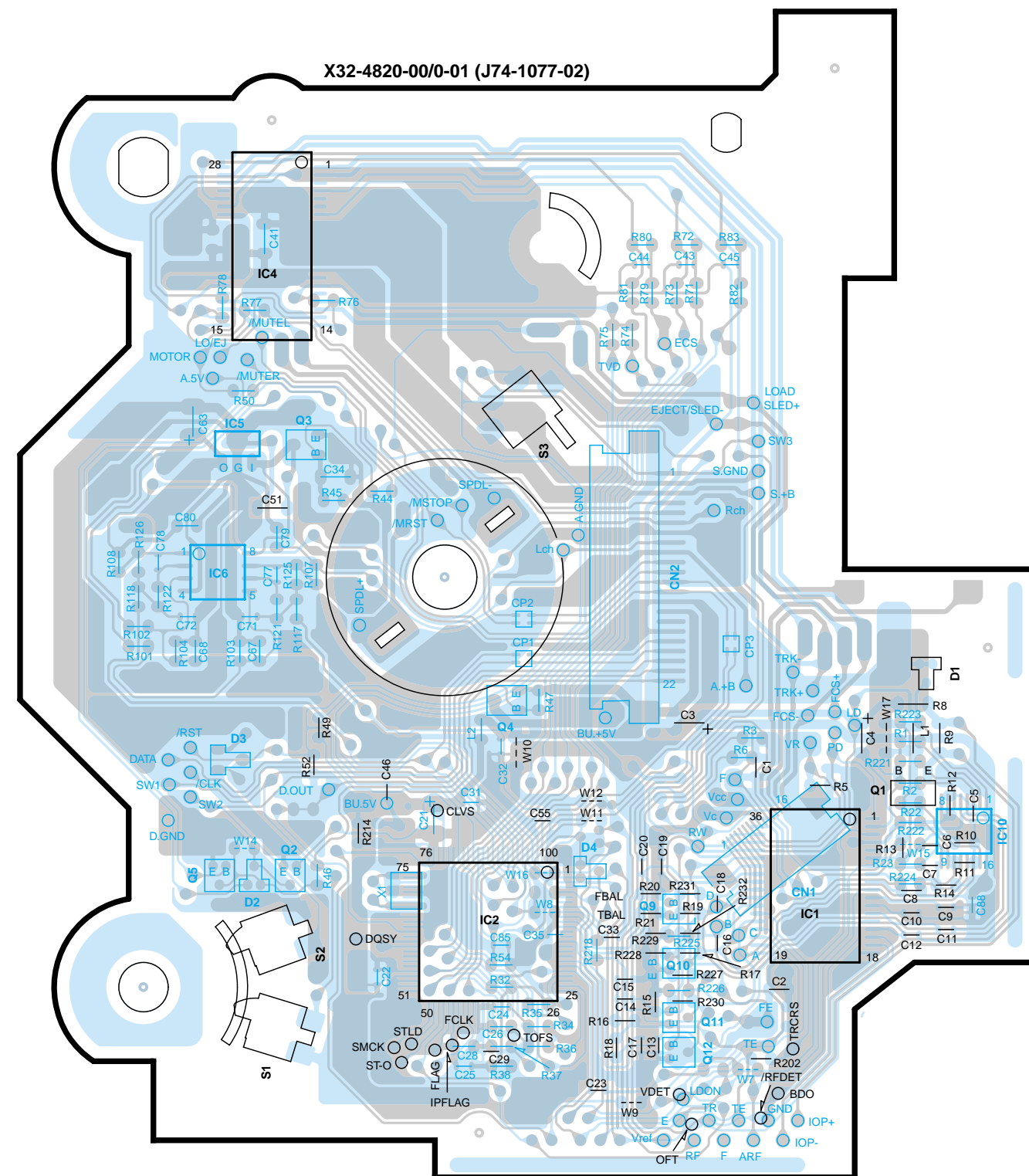

X32-4820-01

IC	Q	Address	IC	Q	Address	IC	Q	Address
1		5AM	10		5AN	5		5AK
2		5AL	1		5AN	9		5AM
4		2AK	2		5AK	10		5AM
5		3AK	3		3AK	11		6AM
6		4AK	4		4AL	12		6AM

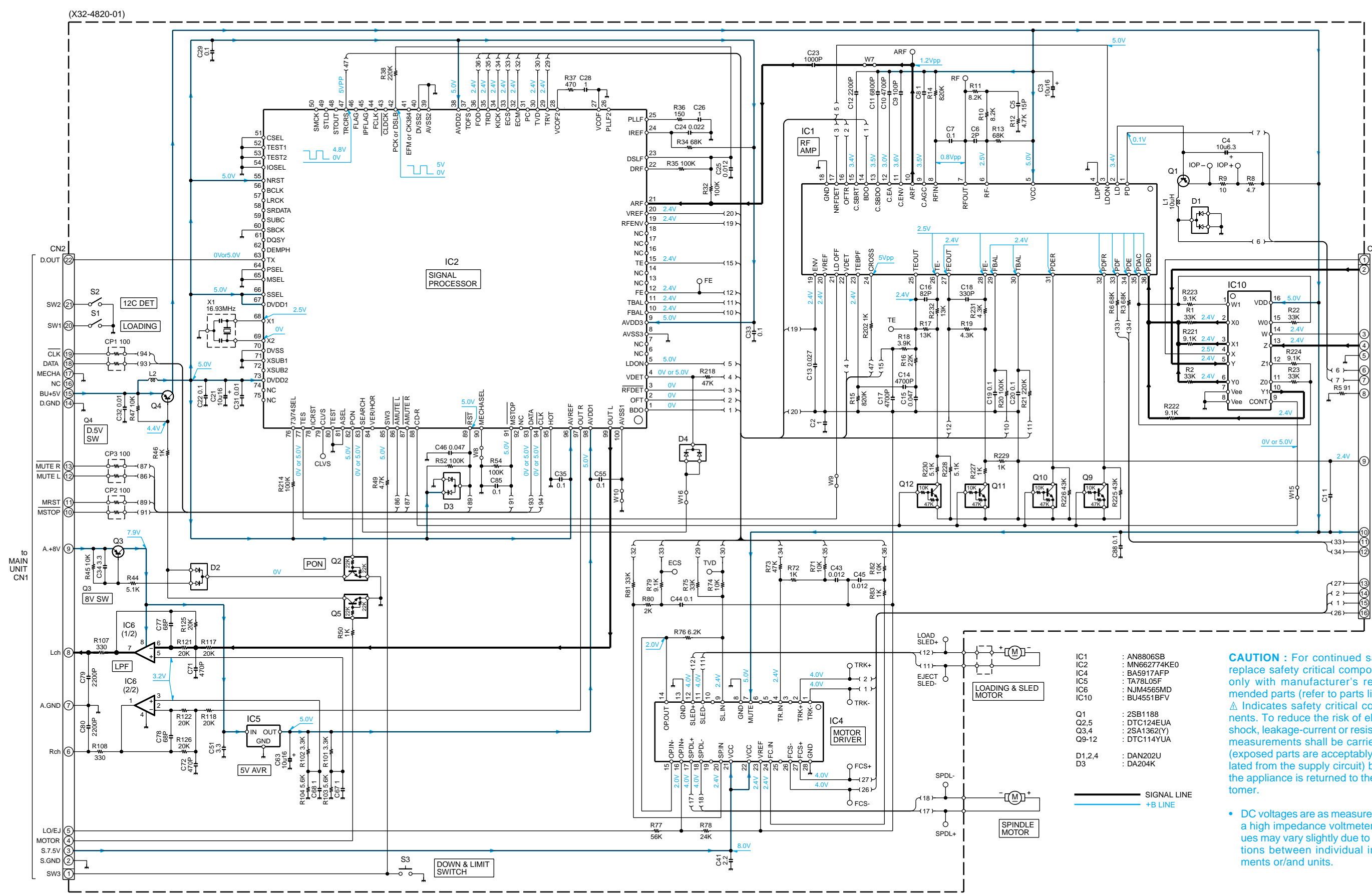

- IC1 : AN8806SB
- IC2 : MN662774KE0
- IC4 : BA5917AFP
- IC5 : TA78L05F
- IC6 : NJM4565MD
- IC10 : BU4551BFV

- Q1 : 2SB1188
- Q2,5 : DTC124EUA
- Q3,4 : 2SA1362(Y)
- Q9-12 : DTC114YUA

- D1,2,4 : DAN202U
- D3 : DA204K

— SIGNAL LINE
 —+B LINE

CAUTION : For continued safety, replace safety critical components only with manufacturer's recommended parts (refer to parts list).
 ▲ Indicates safety critical components. To reduce the risk of electric shock, leakage-current or resistance measurements shall be carried out (exposed parts are acceptably insulated from the supply circuit) before the appliance is returned to the customer.

• DC voltages are as measured with a high impedance voltmeter. Values may vary slightly due to variations between individual instruments or/and units.

DPX-4010,4010/PH4

KENWOOD

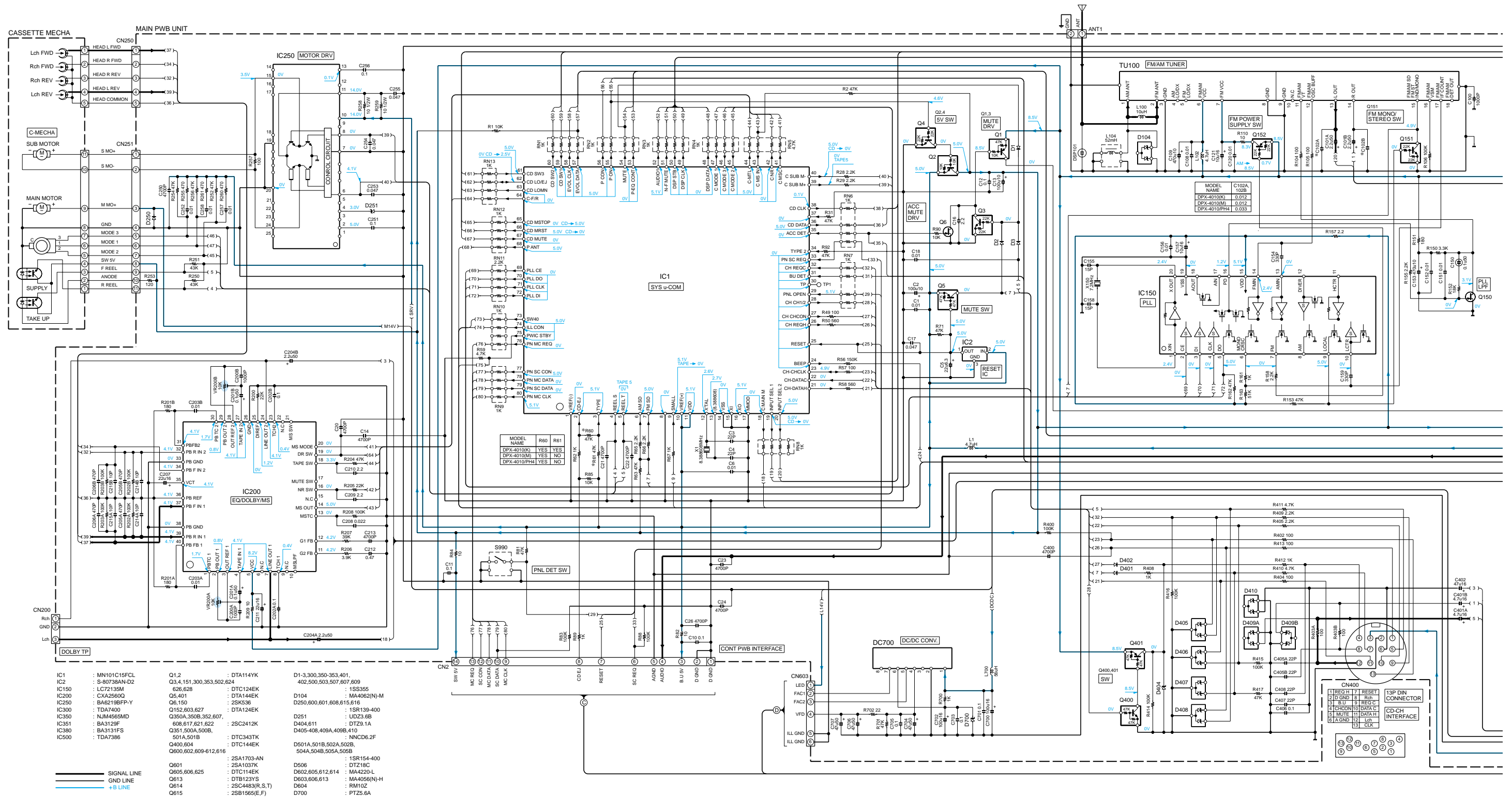

2SB1565

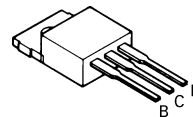

DTA114EK
DTA114YK
DTA124EK
DTA144EK
DTC114EK
DTC114YUA
DTC124EK
DTC144EK

DTC343TK
2SA1362
2SC2412K



2SB1188

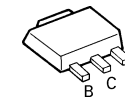

2SA1037K

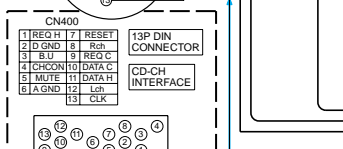
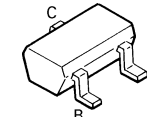

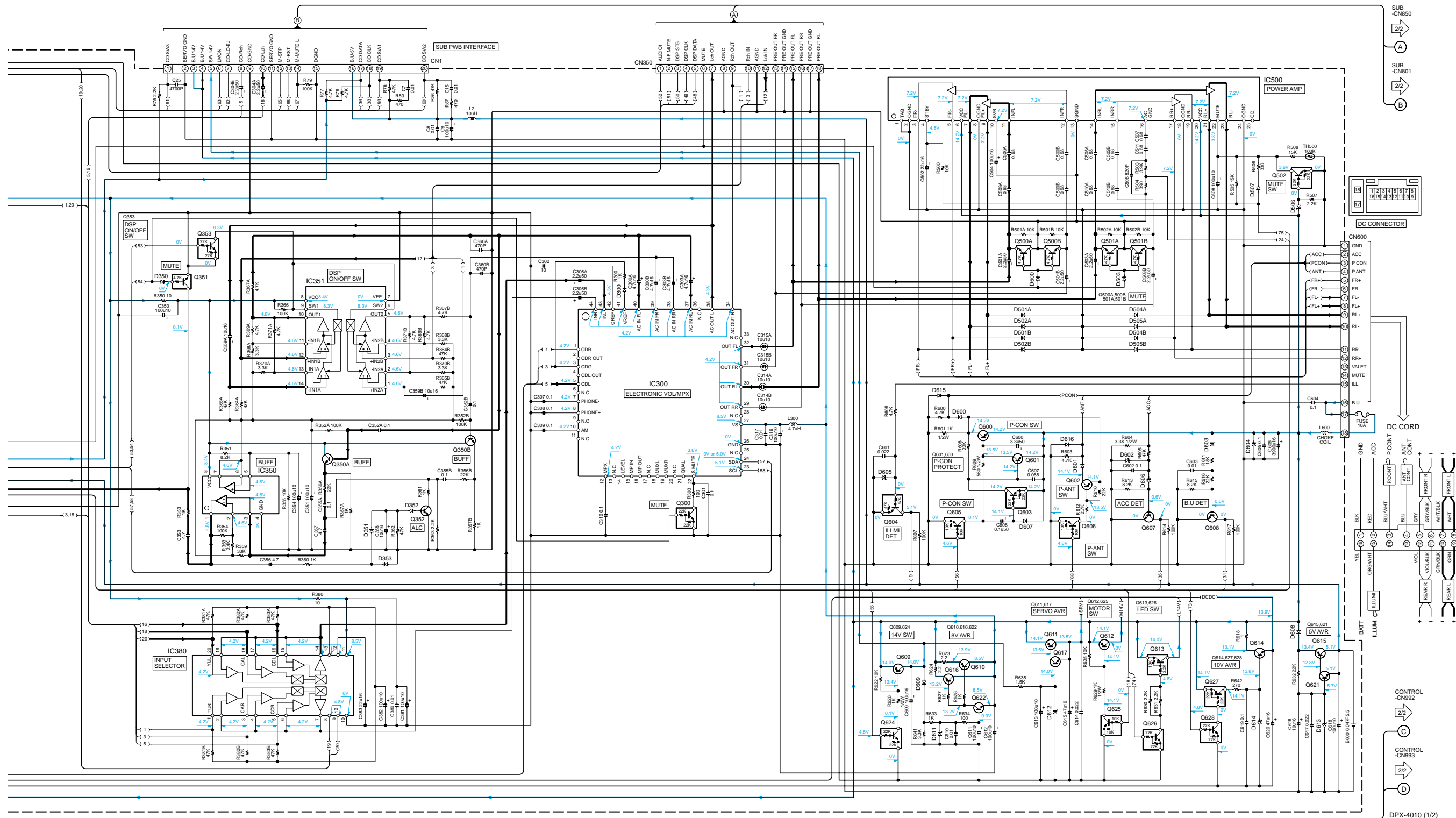

DTC124EUA

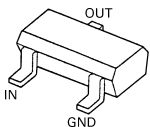

NJM4565MD

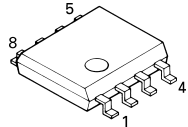

DAN202U



TA78L05F

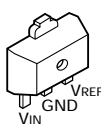

DA204K



2SK536



BA3129F

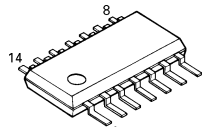

AN8806SB

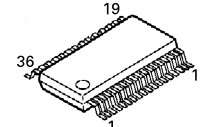

DPX-4010,4010/PH4

KENWOOD

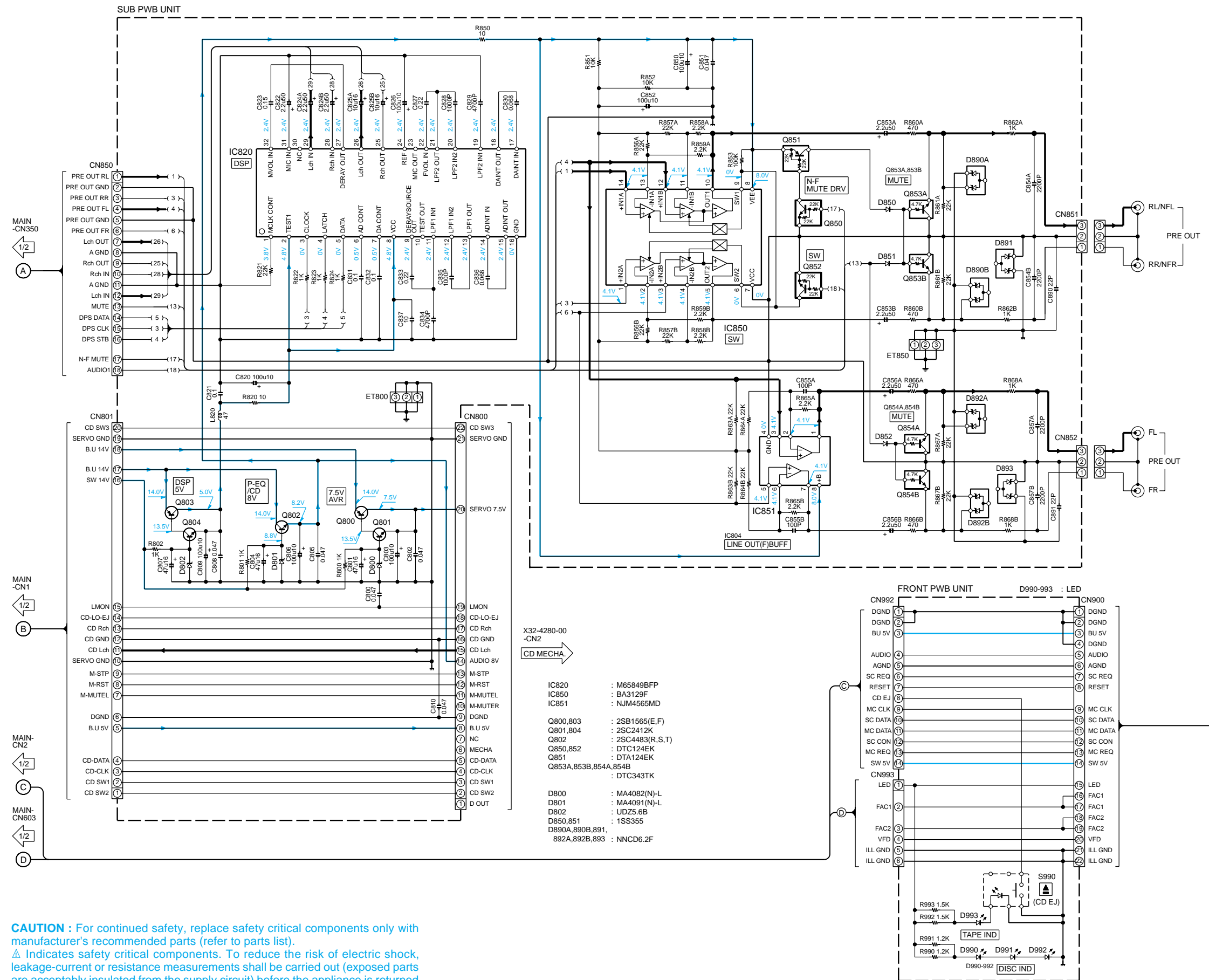

CAUTION : For continued safety, replace safety critical components only with manufacturer's recommended parts (refer to parts list).
 ⚠ Indicates safety critical components. To reduce the risk of electric shock, leakage-current or resistance measurements shall be carried out (exposed parts are acceptably insulated from the supply circuit) before the appliance is returned to the customer.

• DC voltages are as measured with a high impedance voltmeter. Values may vary slightly due to variations between individual instruments or/and units.

CONTROL PWB UNIT

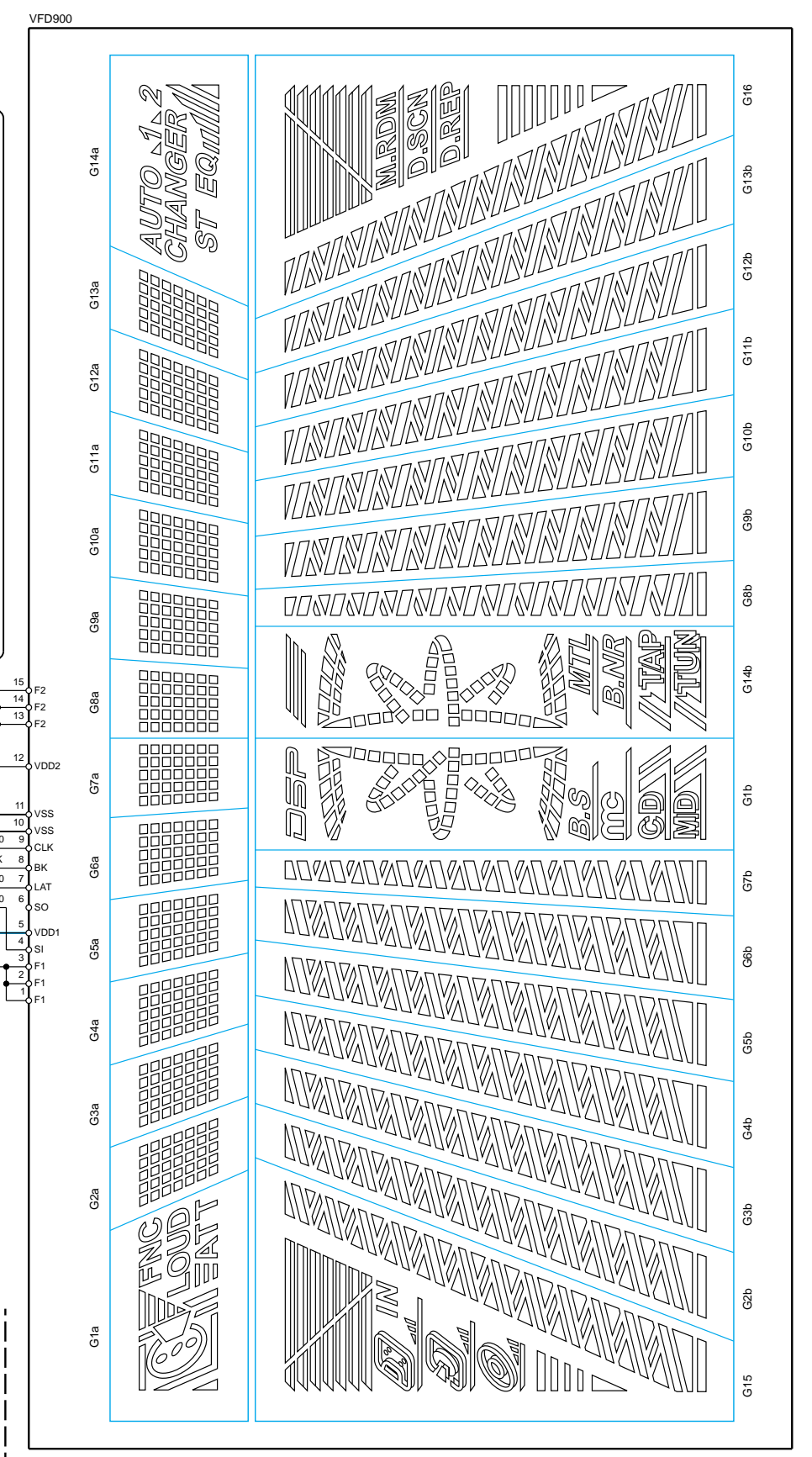
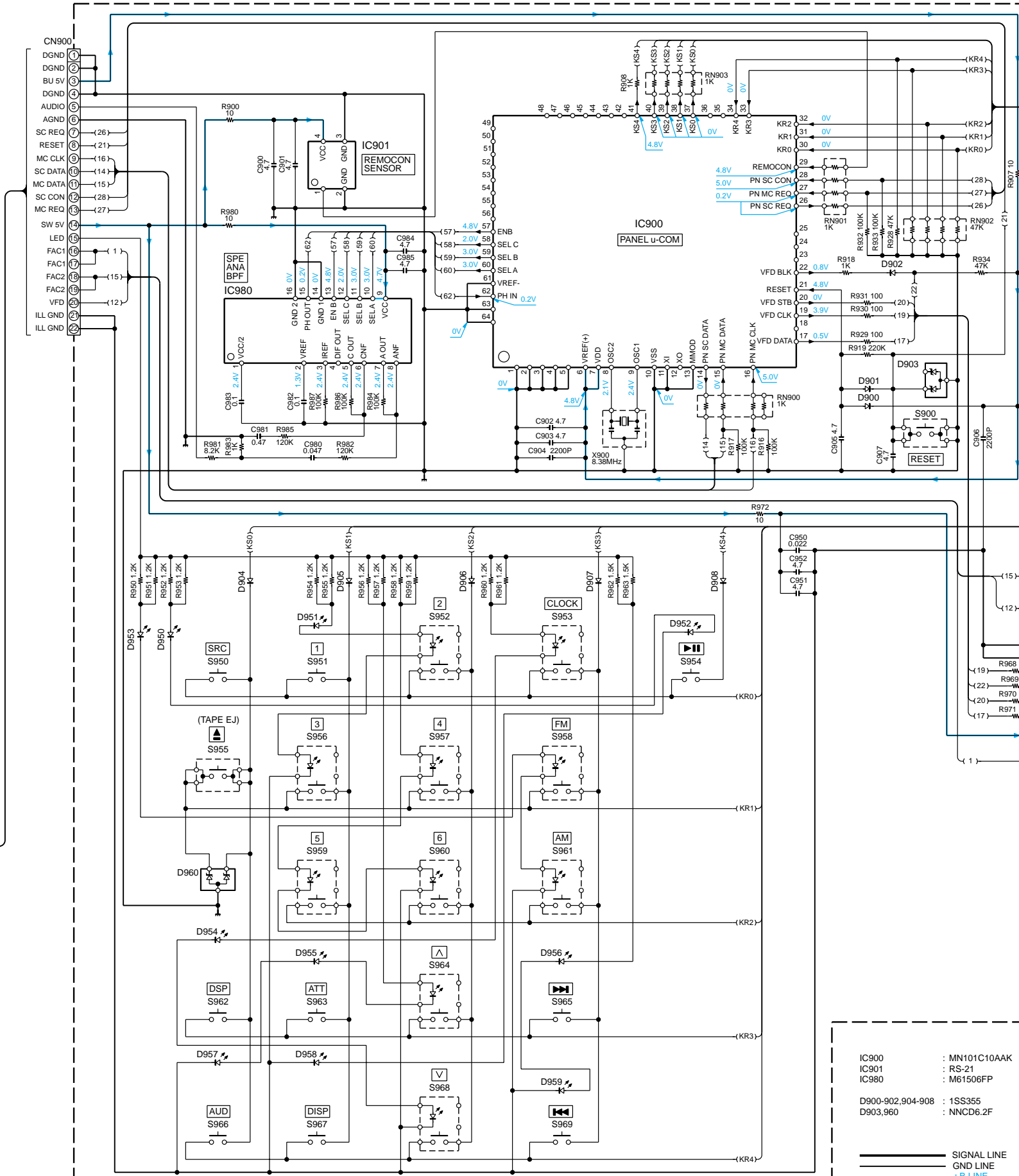

IC900	: MN101C10AAK
IC901	: RS-21
IC980	: M61506FP
D900-902,904-908	: 1SS355
D903,960	: NNCD6.2F

——— SIGNAL LINE
 ——— GND LINE
 ——— +B LINE

DPX-4010,4010/PH4 EXPLODED VIEW (CASSETTE MECHANISM)

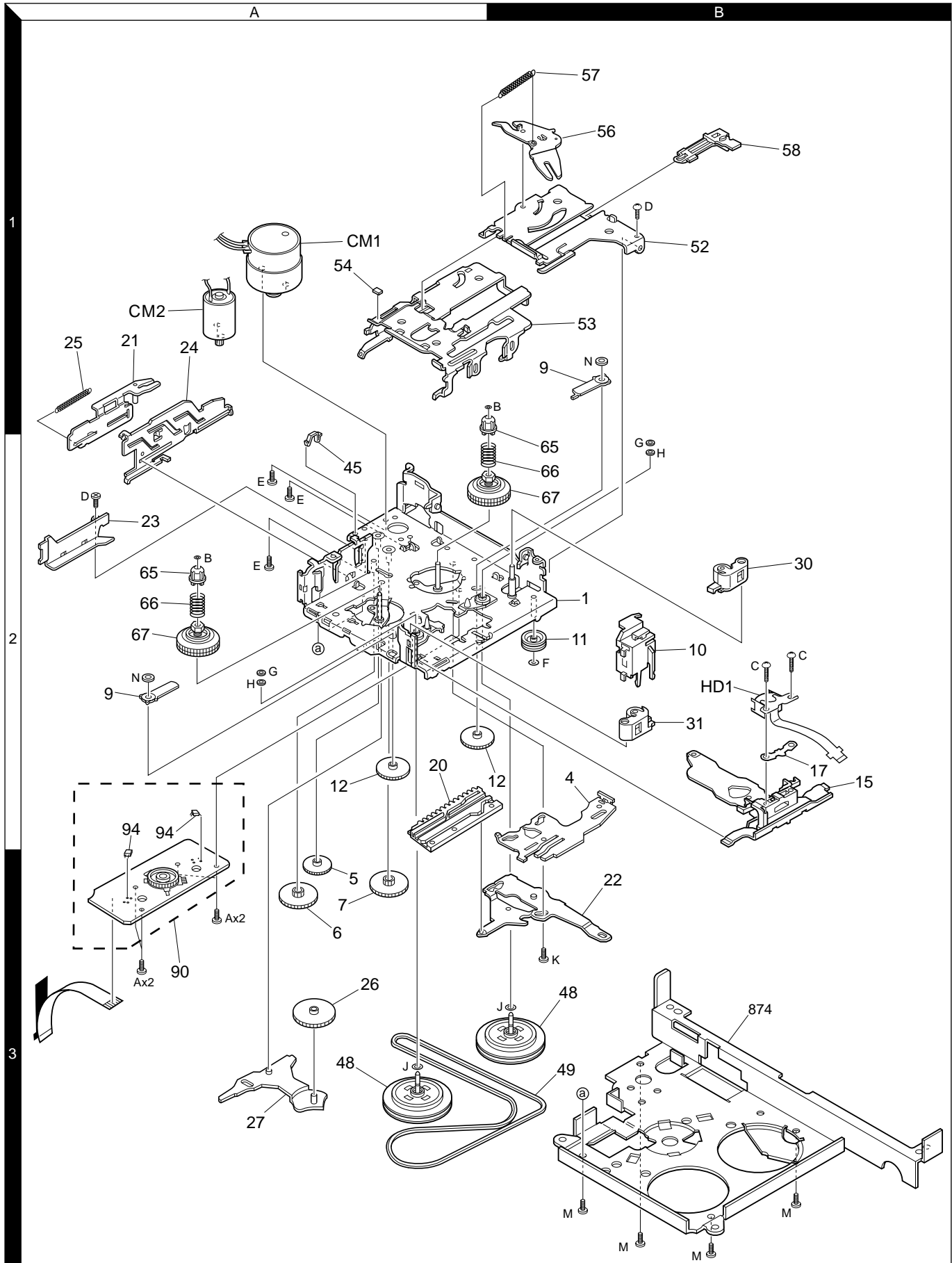

DPX-4010,4010/PH4

EXPLODED VIEW (CD MECHANISM)

- | | | | |
|---|-------------|---|-------------|
| A | M1.7x2.5 | : | N09-4249-05 |
| B | φ2x3.5 | : | N09-4172-05 |
| C | M1.7x4 | : | N09-4202-05 |
| D | M2x2 | : | N38-2020-46 |
| E | φ2x6 | : | N09-4294-05 |
| F | WASHER φ1.2 | : | N19-2023-04 |
| G | WASHER φ1.6 | : | N19-2058-04 |
| H | WASHER φ1.6 | : | N19-2093-04 |
| J | M2x2 | : | N39-2020-46 |

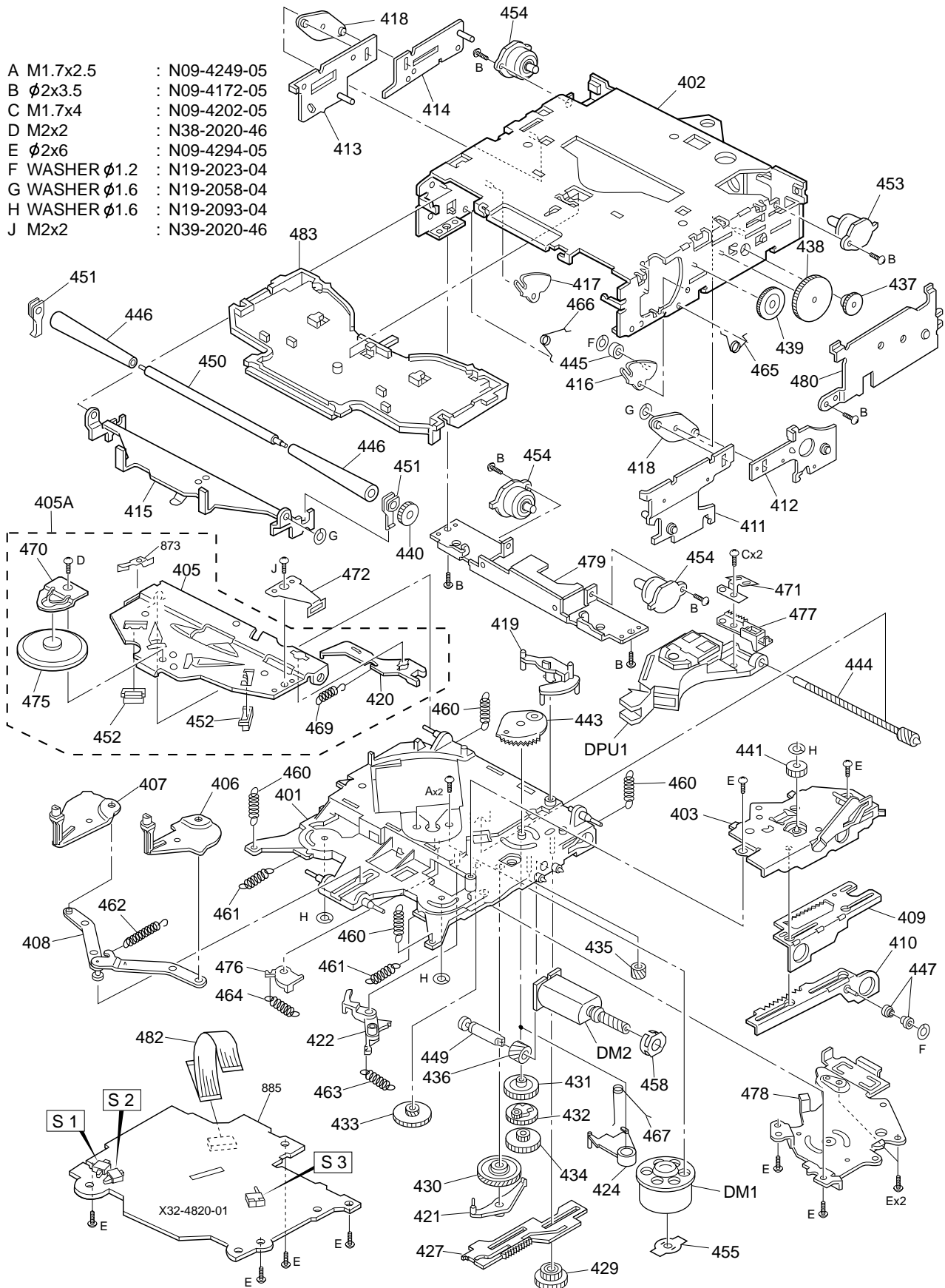

DPX-4010,4010/PH4

EXPLODED VIEW (UNIT)

- L ϕ 2x8 : N80-2008-46
- M ϕ 2x6 (BLK) : N80-2006-45
- N M2.6x3 (BLK) : N09-4436-08
- P M2x3.5 (BLK) : N09-4316-08
- Q ϕ 2x2 (BLK) : N09-4306-08
- R ϕ 2x6 : N82-2006-46
- S ϕ 3x8 : N09-4434-08

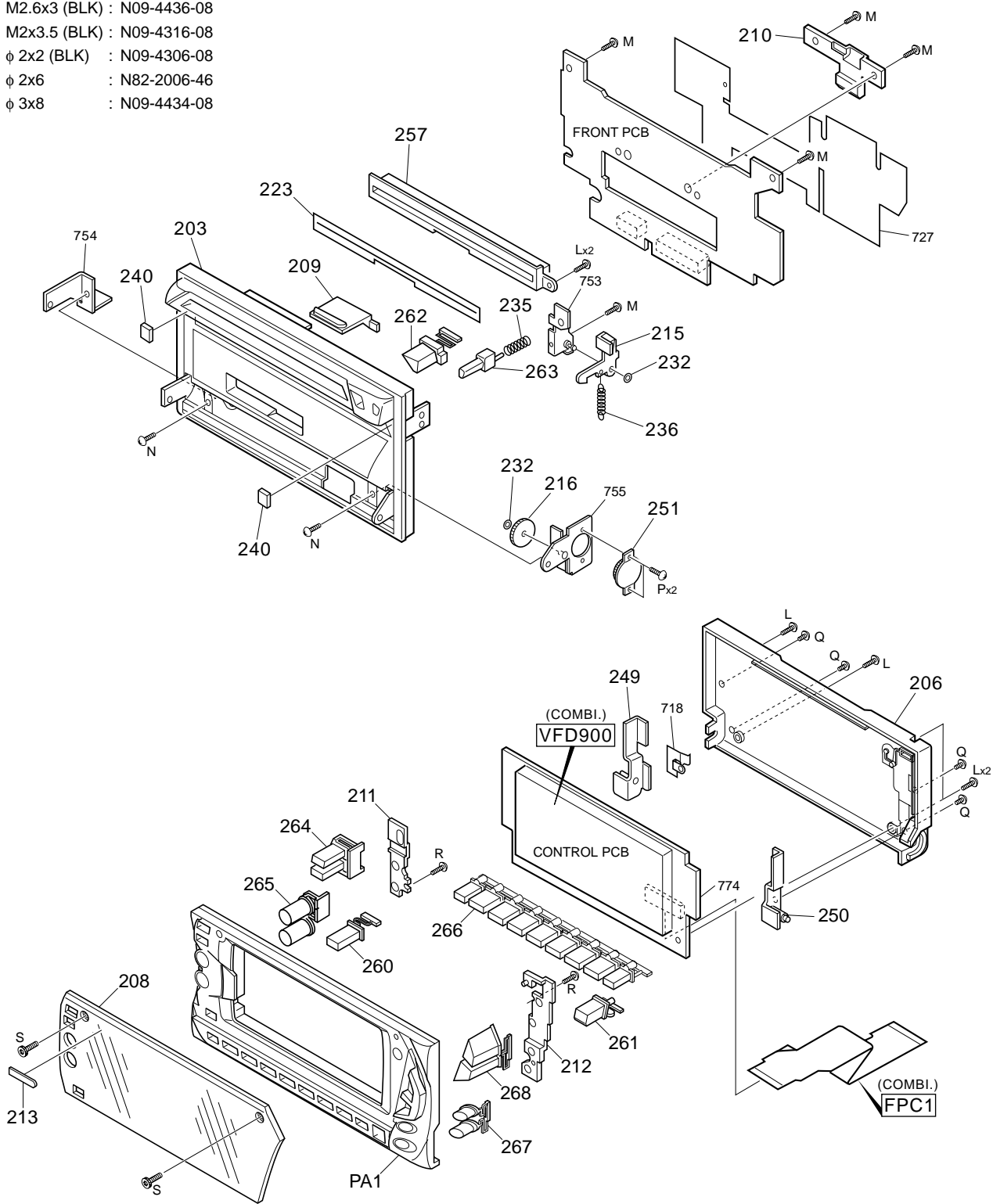

PARTS LIST

* New parts

Parts without **Parts No.** are not supplied.

Les articles non mentionnes dans le **Parts No.** ne sont pas fournis.

Teile ohne **Parts No.** werden nicht geliefert.

Ref. No.	Ad	New	Parts No.	Description	Destination
DPX-4010, DPX-4010/PH4					
203	1G	*	A22-2880-08	SUB PANEL (CR)	K
203	1G	*	A22-2881-08	SUB PANEL (CR)	MH
204	1F	*	A52-0743-08	COVER	
206	1H	*	A46-1710-08	REAR PANEL ASSY	K
206	1H	*	A46-1711-08	REAR PANEL ASSY	MH
PA1	3G	*	A64-2284-08	FRONT PANEL ASSY	K
PA1	3G	*	A64-2285-08	FRONT PANEL ASSY	MH
RC1	1E	*	A70-0883-05	REMOTE CONTROLLER ASSY	
207	3G	*	B10-4041-08	FRONT GLASS ASSY	KM
207	3G	*	B10-4043-08	FRONT GLASS ASSY	H
209	1G	*	B19-1174-08	LIGHTING BOARD (CD)	
210	1H	*	B19-1181-08	LIGHTING BOARD (CR)	
211	2G	*	B19-2078-08	LIGHTING BOARD (L)	
212	3H	*	B19-2079-08	LIGHTING BOARD (R)	
213	3G	*	B43-1240-04	BADGE	
-		*	B46-0100-50	WARRANTY CARD	
-		*	B64-1724-00	INST.MANUAL (ENG.FRE.SPA.)	K
-		*	B64-1725-00	INST.MANUAL (ENGLISH,CHINESE)	MH
-		*	B64-1729-00	INST.MANUAL (KOREAN)M	
215	1H	*	D10-4308-08	LEVER (OPENNER)	
216	2G	*	D13-1452-08	GEAR	
CME1	2F	*	D40-1155-08	CASSETTE MECHANISM ASSY	
221	1E	*	E30-4927-08	4P RCA CORD ASSY	
DC1	1E	*	E30-4860-08	DC CORD ASSY	KM
FC1	1F	*	E39-0402-08	22P FLAT CABLE	
223	1G	*	F19-1372-08	DUST COVER	
231	2E	*	F29-0049-05	INSULATING COVER	
232	2H	*	F29-0618-08	C WASHER	
233	1E	*	G02-1313-08	FLAT SPRING ASSY	
235	1H	*	G02-1315-08	SPRING (RELESE)	
236	1H	*	G02-1316-08	SPRING (LEVER)	
237	3E	*	G02-1318-08	SPRING (CLOSE)	
238	3E	*	G09-2039-08	SPRING (OPEN)	
240	1G	*	G11-1934-08	CUSHION (ILLUMI)	
-		*	H10-4734-08	POLYSTYRENE FOAMED FIXTURE (L)	
-		*	H10-4735-08	POLYSTYRENE FOAMED FIXTURE (R)	
-		*	H25-0336-04	PROTECTION BAG (170x290)	
-		*	H25-1127-04	PROTECTION BAG	
-		*	H54-1789-08	ITEM CARTON CASE	K
-		*	H54-1790-08	ITEM CARTON CASE	M
-		*	H54-1855-08	ITEM CARTON CASE	H
249	2H	*	J19-4905-08	PANEL HOLDER (R) ASSY	
250	3H	*	J19-4907-08	PANEL HOLDER (L) ASSY	
251	2H	*	J19-4913-08	OIL DAMPER	
256	1E	*	J21-9578-05	HONDA ATTACH KIT	KM
256	1E	*	J21-9617-05	HONDA ATTACH KIT (PH4)	H
257	1G	*	J90-1000-08	DISC GUIDE	
260	3G	*	K24-3654-08	KNOB (SA)	
261	3H	*	K24-3673-08	KNOB (SRC)	K

Ref. No.	Ad	New	Parts No.	Description	Destination
261	3H	*	K24-3674-08	KNOB (SRC)	MH
262	1G	*	K24-3675-08	KNOB (CD/EJ)	K
262	1G	*	K24-3676-08	KNOB (CD/EJ)	MH
263	1G	*	K24-3677-08	KNOB (RELEASE)	K
263	1G	*	K24-3678-08	KNOB (RELEASE)	MH
264	2G	*	K25-1234-08	KNOB (AUD/ATT)	
265	3G	*	K25-1261-08	KNOB (VOL)	
266	3H	*	K25-1236-08	KNOB (PRESET)	
267	3H	*	K25-1262-08	KNOB (AM/FM)	K
267	3H	*	K25-1263-08	KNOB (AM/FM)	MH
268	3H	*	K25-1239-08	KNOB (SEEK)	
271	1E	*	N99-1671-08	SCREW SET	
A	3E	*	N30-3006-46	SCREW (M3X6)	
B	2E	*	N09-4433-08	SCREW (3X8,BLK)	
D	3E	*	N83-3006-46	SCREW (3X6,B)	
E	1F	*	N09-4315-08	SCREW (M2X2.5)	
F	1E	*	N84-3006-46	SCREW (3X6,S)	
G	2F	*	N86-3006-41	SCREW (3X6,S)	
J	1E	*	N35-2004-46	SCREW (2X4,S)	
K	3E	*	N09-4308-08	SCREW (M2X4)	
L	2H	*	N80-2008-46	SCREW (2X8,P)	
M	1H	*	N80-2006-45	SCREW (2X6,P,BLK)	
N	2G	*	N09-4436-08	SCREW (M2.6X3,BLK)	
P	2H	*	N09-4316-08	SCREW (M2X3.5,BLK)	
Q	2H	*	N09-4306-08	SCREW (2X2,BLK)	
R	3H	*	N82-2006-46	SCREW (2X6,P)	
S	3G	*	N09-4434-08	SCREW (3X8)	MH
DME1	1F	*	X92-3900-01	CD MECHANISM ASSY (DXM-1051)	
MAIN PWB UNIT					
B600		*	C90-5360-08	ELECTRO 0.047F 5.5V	
C1		*	CK73GB1H103K	CHIP C 0.010UF K	
C2		*	CE04CW1A101M	ELECTRO 100UF 10WV	
C3,4		*	CC73GCH1H220J	CHIP C 22PF J	
C5		*	CE04CW0J220M	ELECTRO 22UF 6.3WV	
C6-8		*	CK73GB1H103K	CHIP C 0.010UF K	
C9		*	CE04CW1A101M	ELECTRO 100UF 10WV	
C10-12		*	CK73GB1C104K	CHIP C 0.10UF K	
C13		*	CE04CW1A101M	ELECTRO 100UF 10WV	
C14		*	CK73GB1H472K	CHIP C 4700PF K	
C15		*	CK73GB1H103K	CHIP C 0.010UF K	
C16		*	CK73FB1C225K	CHIP C 2.2UF K	
C17		*	CK73GB1E473K	CHIP C 0.047UF K	
C18		*	CK73GB1H103K	CHIP C 0.010UF K	
C20-26		*	CK73GB1H472K	CHIP C 4700PF K	
C100		*	CK73GB1H102K	CHIP C 1000PF K	
C101A,B		*	C90-2610-05	ELECTRO 2.2UF 50WV	
C102A,B		*	CK73GB1E333K	CHIP C 0.033UF K	H
C102A,B		*	CK73GB1H123K	CHIP C 0.012UF K	KM
C108		*	CK73GB1H103K	CHIP C 0.010UF K	
C109		*	C90-2949-08	ELECTRO 470UF 10WV	
C120		*	CK73GB1H103K	CHIP C 0.010UF K	
C121		*	C90-2597-05	ELECTRO 10UF 16WV	
C150		*	C90-5225-08	ELECTRO 0.1UF 50WV	

E : Europe K : North America M : Other Areas
W : Without Europe

K : DPX-4010 (K type)
M : DPX-4010 (M type)
H : DPX-4010/PH4

△ Indicates safety critical components.

PARTS LIST

* New parts

Parts without **Parts No.** are not supplied.

Les articles non mentionnes dans le **Parts No.** ne sont pas fournis.

Teile ohne **Parts No.** werden nicht geliefert.

MAIN PWB UNIT

Ref. No.	A d d	N e w	Parts No.	Description	Desti- nation	Ref. No.	A d d	N e w	Parts No.	Description	Desti- nation
C151,152			CK73GB1H103K	CHIP C 0.010UF K		C405A,B			CC73FCH1H220J	CHIP C 22PF J	
C153			C90-2949-08	ELECTRO 470UF 10WV		C406			CK73FB1H104K	CHIP C 0.10UF K	
C154			CC73GCH1H331J	CHIP C 330PF J		C407,408			CC73FCH1H220J	CHIP C 22PF J	
C155			CC73GCH1H150J	CHIP C 15PF J		C500A,B			CK73FB1A684K	CHIP C 0.68UF K	
C156			CK73GB1H103K	CHIP C 0.010UF K		C501A,B			C90-2610-05	ELECTRO 2.2UF 50WV	
C157			C90-2597-05	ELECTRO 10UF 16WV		C502			CE04CW1C220M	ELECTRO 22UF 16WV	
C158			CC73GCH1H150J	CHIP C 15PF J		C503A,B			C90-2610-05	ELECTRO 2.2UF 50WV	
C159			CC73GCH1H331J	CHIP C 330PF J		C504			CE04CW1C101M	ELECTRO 100UF 16WV	
C200A,B			CK73GB1H102K	CHIP C 1000PF K		C505A,B			CK73FB1A684K	CHIP C 0.68UF K	
C201A,B			CE04CW1H0R1M	ELECTRO 0.1UF 50WV		C506			CK73GB1H821K	CHIP C 820PF K	
C202A,B			CK73GB1C104K	CHIP C 0.10UF K		C507			CK73FB1A684K	CHIP C 0.68UF K	
C203A,B			CK73GB1H103K	CHIP C 0.010UF K		C508			CE04CW1A101M	ELECTRO 100UF 10WV	
C204A,B			C90-2610-05	ELECTRO 2.2UF 50WV		C509A,B			CK73FB1A684K	CHIP C 0.68UF K	
C205A,B			CC73GCH1H471J	CHIP C 470PF J		C510A,B			CK73FB1A684K	CHIP C 0.68UF K	
C206A,B			CC73GCH1H471J	CHIP C 470PF J		C511			CK73FB1A684K	CHIP C 0.68UF K	
C207			CE04CW1C220M	ELECTRO 22UF 16WV		C600			CE04CW1H3R3M	ELECTRO 3.3UF 50WV	
C208			CK73GB1H223K	CHIP C 0.022UF K		C601			CK73GB1H223K	CHIP C 0.022UF K	
C209,210			CK73FB1C225K	CHIP C 2.2UF K		C602			CK73GB1C104K	CHIP C 0.10UF K	
C211			CE04CW1C220M	ELECTRO 22UF 16WV		C603			CK73GB1H103K	CHIP C 0.010UF K	
C212			CK73FB1C474K	CHIP C 0.47UF K		C604			CK73EB1H104K	CHIP C 0.10UF K	
C213			CK73GB1H472K	CHIP C 4700PF K		C605			CK73GB1C104K	CHIP C 0.10UF K	
C214A,B			CC73GCH1H100D	CHIP C 10PF D		C606			C90-5328-08	ELECTRO 3900UF 16WV	
C215A,B			CC73GCH1H100D	CHIP C 10PF D		C607			CK73GB1C683K	CHIP C 0.068UF K	
C250			CK73GB1H472K	CHIP C 4700PF K		C608			CE04CW1H0R1M	ELECTRO 0.1UF 50WV	
C251			CK73GB1C104K	CHIP C 0.10UF K		C609			CE04CW1C101M	ELECTRO 100UF 16WV	
C252			CK73GB1H103K	CHIP C 0.010UF K		C610			CK73GB1H103K	CHIP C 0.010UF K	
C253-255			CK73GB1E473K	CHIP C 0.047UF K		C611-613			CE04CW1A101M	ELECTRO 100UF 10WV	
C256			CK73GB1C104K	CHIP C 0.10UF K		C614			CK73GB1H223K	CHIP C 0.022UF K	
C257,258			CK73GB1H103K	CHIP C 0.010UF K		C615			CE04CW1C470M	ELECTRO 47UF 16WV	
C300A,B			C90-2595-05	ELECTRO 4.7UF 16WV		C616			C90-2597-05	ELECTRO 10UF 16WV	
C301			CK73GB1C104K	CHIP C 0.10UF K		C617			CK73GB1H223K	CHIP C 0.022UF K	
C302			C90-5327-08	CHIP-TAN 10UF 16WV		C618			CE04CW1A101M	ELECTRO 100UF 10WV	
C303A,B			C90-2595-05	ELECTRO 4.7UF 16WV		C619			CK73GB1C104K	CHIP C 0.10UF K	
C304A,B			C90-2610-05	ELECTRO 2.2UF 50WV		C620			CE04CW1C470M	ELECTRO 47UF 16WV	
C306A,B			C90-2610-05	ELECTRO 2.2UF 50WV		C700			CE04CW1C101M	ELECTRO 100UF 16WV	
C307-310			CK73GB1C104K	CHIP C 0.10UF K		C701			CK73GB1C104K	CHIP C 0.10UF K	
C314A,B			C90-2594-05	ELECTRO 10UF 10WV		C702			CE04CW1C101M	ELECTRO 100UF 16WV	
C315A,B			C90-2594-05	ELECTRO 10UF 10WV		C703			CK73GB1C104K	CHIP C 0.10UF K	
C316			CE04CW1A101M	ELECTRO 100UF 10WV		C704			CE04DW1H470M	ELECTRO 47UF 50WV	
C317			CK73GB1H103K	CHIP C 0.010UF K		C705			CK73FB1H104K	CHIP C 0.10UF K	
C350,351			CE04CW1A101M	ELECTRO 100UF 10WV		C706,707			CE04DW1H470M	ELECTRO 47UF 50WV	
C352A,B			CK73GB1C104K	CHIP C 0.10UF K		ANT1	*		E04-0318-08	ANT JACK	
C353			CK73FB1C475K	CHIP C 4.7UF K		CN1			E40-9671-08	20P CONNECTOR	
C354			CE04CW1A101M	ELECTRO 100UF 10WV		CN2			E40-9755-08	14P CONNECTOR	
C355A,B			CK73GB1C104K	CHIP C 0.10UF K		CN200			E40-3238-05	3P PIN ASSY	
C356,357			CK73FB1C475K	CHIP C 4.7UF K		CN250			E41-0050-08	5P CONNECTOR	
C358			C90-2597-05	ELECTRO 10UF 16WV		CN251			E41-0051-08	11P CONNECTOR	
C359A,B			C90-2597-05	ELECTRO 10UF 16WV		CN350	*		E41-0110-08	18P CONNECTOR	
C360A,B			CC73GCH1H471J	CHIP C 470PF J		CN400			E56-0834-05	13P DIN CONNECTOR	
C380			CK73GB1H103K	CHIP C 0.010UF K		CN600			E03-0403-08	DC CONNECTOR	
C381,382			CE04CW1A101M	ELECTRO 100UF 10WV		CN603			E40-9586-08	6P CONNECTOR	
C383			CE04CW1C220M	ELECTRO 22UF 16WV		FC2	2E	*	E39-0403-08	18P FLAT CABLE	
C400			CK73GB1H472K	CHIP C 4700PF K		FC3	2E	*	E39-0275-08	20P FLAT CABLE	
C401A,B			C90-2595-05	ELECTRO 4.7UF 16WV							
C402			CE04CW1C470M	ELECTRO 47UF 16WV							

E : Europe K : North America M : Other Areas
W : Without Europe

K : DPX-4010 (K type)
M : DPX-4010 (M type)
H : DPX-4010/PH4

△ Indicates safety critical components.

PARTS LIST

* New parts

Parts without **Parts No.** are not supplied.

Les articles non mentionnes dans le **Parts No.** ne sont pas fournis.

Teile ohne **Parts No.** werden nicht geliefert.

MAIN PWB UNIT

Ref. No.	A d d	N e w	Parts No.	Description	Desti- nation	Ref. No.	A d d	N e w	Parts No.	Description	Desti- nation
F1	2E		F06-1032-05	FUSE 10A		R157			RK73GB1J2R2J	CHIP R 2.2 J 1/16W	
L1			L33-1111-08	CHOKE COIL 4.7uH		R158			RK73GB1J222J	CHIP R 2.2K J 1/16W	
L2			L33-1112-08	CHOKE COIL 10uH		R161			RK73GB1J102J	CHIP R 1.0K J 1/16W	
L100			L33-1112-08	CHOKE COIL 10uH		R162			RK73GB1J473J	CHIP R 47K J 1/16W	
L102			L33-1111-08	CHOKE COIL 4.7uH		R163			RK73GB1J513J	CHIP R 51K J 1/16W	
L104			L33-1123-05	ANT COIL 52mH		R200			RK73GB1J223J	CHIP R 22K J 1/16W	
L300			L33-1111-08	CHOKE COIL 4.7uH		R201A,B			RK73GB1J181J	CHIP R 180 J 1/16W	
L700			L33-1090-08	CHOKE COIL 56uH		R202A,B			RK73GB1J104J	CHIP R 100K J 1/16W	
X1		*	L77-2761-08	X'TAL 8.388608MHz		R203A,B			RK73GB1J104J	CHIP R 100K J 1/16W	
X150		*	L77-2762-08	X'TAL 7.200MHz		R204			RK73GB1J473J	CHIP R 47K J 1/16W	
B	2E	*	N09-4433-08	SCREW (3X8,S,BLK)		R205			RK73GB1J223J	CHIP R 22K J 1/16W	
C	2E		N30-3008-46	SCREW (3X8,S)		R206			RK73GB1J392J	CHIP R 3.9K J 1/16W	
H	2E		N86-2606-46	SCREW (2.6X8,S)		R207			RK73GB1J393J	CHIP R 39K J 1/16W	
R1			RK73GB1J103J	CHIP R 10K J 1/16W		R208			RK73GB1J104J	CHIP R 100K J 1/16W	
R2			RK73GB1J473J	CHIP R 47K J 1/16W		R209			RK73GB1J100J	CHIP R 10 J 1/16W	
R28,29			RK73GB1J222J	CHIP R 2.2K J 1/16W		R250,251			RK73GB1J433J	CHIP R 43K J 1/16W	
R31			RK73GB1J473J	CHIP R 47K J 1/16W		R252			RK73GB1J473J	CHIP R 47K J 1/16W	
R49			RK73GB1J101J	CHIP R 100 J 1/16W		R253			RK73GB1J121J	CHIP R 120 J 1/16W	
R50			RK73GB1J561J	CHIP R 560 J 1/16W		R254			RK73GB1J473J	CHIP R 47K J 1/16W	
R56			RK73GB1J154J	CHIP R 150K J 1/16W		R255			RK73GB1J471J	CHIP R 470 J 1/16W	
R57			RK73GB1J101J	CHIP R 100 J 1/16W		R256			RK73GB1J473J	CHIP R 47K J 1/16W	
R58			RK73GB1J561J	CHIP R 560 J 1/16W		R258,259			RS14DB2H100J	FL-PROOF RS 10 J 1/2W	
R59			RK73GB1J472J	CHIP R 4.7K J 1/16W		R260,261			RK73GB1J471J	CHIP R 470 J 1/16W	
R60			RK73GB1J473J	CHIP R 47K J 1/16W		R300			RK73GB1J102J	CHIP R 1.0K J 1/16W	
R61			RK73GB1J473J	CHIP R 47K J 1/16W	K	R303			RK73GB1J101J	CHIP R 100 J 1/16W	
R62			RK73GB1J102J	CHIP R 1.0K J 1/16W		R350			RK73GB1J100J	CHIP R 10 J 1/16W	
R63			RK73GB1J473J	CHIP R 47K J 1/16W		R351			RK73GB1J822J	CHIP R 8.2K J 1/16W	
R65,66			RK73GB1J222J	CHIP R 2.2K J 1/16W		R352A,B			RK73GB1J104J	CHIP R 100K J 1/16W	
R67			RK73GB1J102J	CHIP R 1.0K J 1/16W		R353			RK73GB1J102J	CHIP R 1.0K J 1/16W	
R71			RK73GB1J473J	CHIP R 47K J 1/16W		R354			RK73GB1J104J	CHIP R 100K J 1/16W	
R75			RK73GB1J222J	CHIP R 2.2K J 1/16W		R355			RK73GB1J103J	CHIP R 10K J 1/16W	
R76,77			RK73GB1J472J	CHIP R 4.7K J 1/16W		R356A,B			RK73GB1J223J	CHIP R 22K J 1/16W	
R78			RK73GB1J473J	CHIP R 47K J 1/16W		R357A,B			RK73GB1J102J	CHIP R 1.0K J 1/16W	
R79			RK73GB1J104J	CHIP R 100K J 1/16W		R358			RK73GB1J242J	CHIP R 2.4K J 1/16W	
R80			RK73GB1J471J	CHIP R 470 J 1/16W		R359			RK73GB1J333J	CHIP R 33K J 1/16W	
R81			RK73GB1J473J	CHIP R 47K J 1/16W		R360			RK73GB1J102J	CHIP R 1.0K J 1/16W	
R82			RK73GB1J100J	CHIP R 10 J 1/16W		R361			RK73GB1J102J	CHIP R 1.0K J 1/16W	
R83			RK73GB1J104J	CHIP R 100K J 1/16W		R362			RK73GB1J473J	CHIP R 47K J 1/16W	
R84			RK73GB1J100J	CHIP R 10 J 1/16W		R363			RK73GB1J222J	CHIP R 2.2K J 1/16W	
R85			RK73GB1J103J	CHIP R 10K J 1/16W		R364A,B			RK73GB1J473J	CHIP R 47K J 1/16W	
R86			RK73GB1J473J	CHIP R 47K J 1/16W		R365A,B			RK73GB1J473J	CHIP R 47K J 1/16W	
R87			RK73GB1J471J	CHIP R 470 J 1/16W		R366			RK73GB1J104J	CHIP R 100K J 1/16W	
R88			RK73GB1J104J	CHIP R 100K J 1/16W		R367A,B			RK73GB1J472J	CHIP R 4.7K J 1/16W	
R89			RK73GB1J102J	CHIP R 1.0K J 1/16W		R368A,B			RK73GB1J332J	CHIP R 3.3K J 1/16W	
R90			RK73GB1J103J	CHIP R 10K J 1/16W		R369A,B			RK73GB1J472J	CHIP R 4.7K J 1/16W	
R92			RK73GB1J473J	CHIP R 47K J 1/16W		R370A,B			RK73GB1J332J	CHIP R 3.3K J 1/16W	
R104,105			RK73GB1J101J	CHIP R 100 J 1/16W		R371A,B			RK73GB1J472J	CHIP R 4.7K J 1/16W	
R106			RK73GB1J104J	CHIP R 100K J 1/16W		R380			RK73GB1J100J	CHIP R 10 J 1/16W	
R110			RK73GB1J100J	CHIP R 10 J 1/16W		R381A,B			RK73GB1J473J	CHIP R 47K J 1/16W	
R150			RK73GB1J332J	CHIP R 3.3K J 1/16W		R382A,B			RK73GB1J473J	CHIP R 47K J 1/16W	
R151			RK73EB2B181J	CHIP R 180 J 1/8W		R383A,B			RK73GB1J473J	CHIP R 47K J 1/16W	
R152			RK73GB1J183J	CHIP R 18K J 1/16W		R400			RK73GB1J104J	CHIP R 100K J 1/16W	
R153			RK73GB1J473J	CHIP R 47K J 1/16W		R402			RK73FB2A101J	CHIP R 100 J 1/10W	
R155			RK73GB1J222J	CHIP R 2.2K J 1/16W		R403A,B			RK73FB2A101J	CHIP R 100 J 1/10W	
						R404			RK73FB2A101J	CHIP R 100 J 1/10W	

E : Europe K : North America M : Other Areas
W : Without Europe

K : DPX-4010 (K type)
M : DPX-4010 (M type)
H : DPX-4010/PH4

△ Indicates safety critical components.

DPX-4010,4010/PH4

PARTS LIST

* New parts

Parts without **Parts No.** are not supplied.

Les articles non mentionnés dans le **Parts No.** ne sont pas fournis.

Teile ohne **Parts No.** werden nicht geliefert.

MAIN PWB UNIT

Ref. No.	Add	New	Parts No.	Description	Destination
R405			RK73FB2A222J	CHIP R 2.2K J 1/10W	
R408			RK73GB1J102J	CHIP R 1.0K J 1/16W	
R409			RK73FB2A222J	CHIP R 2.2K J 1/10W	
R410,411			RK73FB2A472J	CHIP R 4.7K J 1/10W	
R412			RK73FB2A102J	CHIP R 1.0K J 1/10W	
R413			RK73FB2A101J	CHIP R 100 J 1/10W	
R414-416			RK73GB1J104J	CHIP R 100K J 1/16W	
R417			RK73GB1J473J	CHIP R 47K J 1/16W	
R500			RK73GB1J103J	CHIP R 10K J 1/16W	
R501A,B			RK73GB1J103J	CHIP R 10K J 1/16W	
R502A,B			RK73GB1J103J	CHIP R 10K J 1/16W	
R503			RK73GB1J392J	CHIP R 3.9K J 1/16W	
R504			RK73GB1J391J	CHIP R 390 J 1/16W	
R505			RK73GB1J153J	CHIP R 15K J 1/16W	
R506			RK73GB1J331J	CHIP R 330 J 1/16W	
R507			RK73EB2B222J	CHIP R 2.2K J 1/8W	
R508			RK73GB1J153J	CHIP R 15K J 1/16W	
R600			RK73GB1J472J	CHIP R 4.7K J 1/16W	
R601			RD14DB2H102J	SMALL-RD 1.0K J 1/2W	
R603			RK73GB1J472J	CHIP R 4.7K J 1/16W	
R604			RD14DB2H332J	SMALL-RD 3.3K J 1/2W	
R605			RK73EB2B473J	CHIP R 47K J 1/8W	
R606			RK73EB2B472J	CHIP R 4.7K J 1/8W	
R607			RK73GB1J104J	CHIP R 100K J 1/16W	
R608			RK73GB1J223J	CHIP R 22K J 1/16W	
R609			RS14DB2H561J	FL-PROOF RS 560 J 1/2W	
R610			RK73GB1J223J	CHIP R 22K J 1/16W	
R611			RK73GB1J183J	CHIP R 18K J 1/16W	
R612			RK73EB2B103J	CHIP R 10K J 1/8W	
R613			RK73GB1J822J	CHIP R 8.2K J 1/16W	
R614			RK73GB1J104J	CHIP R 100K J 1/16W	
R615			RK73GB1J822J	CHIP R 8.2K J 1/16W	
R616			RK73GB1J223J	CHIP R 22K J 1/16W	
R617			RK73GB1J104J	CHIP R 100K J 1/16W	
R618			RK73EB2B1R0J	CHIP R 1.0 J 1/8W	
R622			RK73GB1J103J	CHIP R 10K J 1/16W	
R623,624			RK73GB1J2R2J	CHIP R 2.2 J 1/16W	
R625			RK73GB1J103J	CHIP R 10K J 1/16W	
R626			RD14DB2H102J	SMALL-RD 1.0K J 1/2W	
R627,628			RK73GB1J102J	CHIP R 1.0K J 1/16W	
R629			RD14DB2H102J	SMALL-RD 1.0K J 1/2W	
R630,631			RK73EB2B222J	CHIP R 2.2K J 1/8W	
R632			RK73GB1J223J	CHIP R 22K J 1/16W	
R633			RK73GB1J102J	CHIP R 1.0K J 1/16W	
R634			RK73GB1J101J	CHIP R 100 J 1/16W	
R635			RK73GB1J152J	CHIP R 1.5K J 1/16W	
R641			RK73GB1J332J	CHIP R 3.3K J 1/16W	
R642			RK73GB1J271J	CHIP R 270 J 1/16W	
R700			RK73GB1J102J	CHIP R 1.0K J 1/16W	
R701			RK73GB1J473J	CHIP R 47K J 1/16W	
RN1-4			R90-0724-05	MULTI-COMP 1K X4	
RN5			R90-1042-08		
RN6-10			R90-0724-05	MULTI-COMP 1K X4	
RN11			R90-0722-05	MULTI-COMP 2.2K X4	
RN12,13			R90-0724-05	MULTI-COMP 1K X4	

Ref. No.	Add	New	Parts No.	Description	Destination
VR200A,B			R32-0242-08	SFR 10K	
S990		*	S70-0857-08	PUSH SW	
D1-3			1SS355	DIODE	
D104			MA4062(N)-M	ZENER DIODE	
D250			1SR139-400	DIODE	
D251			UDZ3.6B	ZENER DIODE	
D300			1SS355	DIODE	
D350-353			1SS355	DIODE	
D401,402			1SS355	DIODE	
D404			DTZ9.1A	ZENER DIODE	
D405-408			NNCD6.2F	ZENER DIODE	
D409A,B			NNCD6.2F	ZENER DIODE	
D410			NNCD6.2F	ZENER DIODE	
D500			1SS355	DIODE	
D501A,B			1SR154-400	DIODE	
D502A,B			1SR154-400	DIODE	
D503			1SS355	DIODE	
D504A,B			1SR154-400	DIODE	
D505A,B			1SR154-400	DIODE	
D506			DTZ18C	ZENER DIODE	
D507			1SS355	DIODE	
D600,601			1SR139-400	DIODE	
D602			MA4220-L	ZENER DIODE	
D603			MA4056(N)-H	DIODE	
D604			RM10Z	DIODE	
D605			MA4220-L	ZENER DIODE	
D606			MA4056(N)-H	DIODE	
D607			1SS355	DIODE	
D608			1SR139-400	DIODE	
D609			1SS355	DIODE	
D611			DTZ9.1A	ZENER DIODE	
D612			MA4220-L	ZENER DIODE	
D613			MA4056(N)-H	DIODE	
D614			MA4220-L	ZENER DIODE	
D615,616			1SR139-400	DIODE	
D700			PTZ5.6A	ZENER DIODE	
DSP101			DSP-201M-S00B	SURGE ABSORBER	
IC1		*	MN101C15FCJ	IC	
IC2			S-80738AN-D2	IC	
IC150			LC72135M	IC	
IC200			CXA2560Q	IC	
IC250			BA6219BFP-Y	IC	
IC300			TDA7400	IC	
IC350			NJM4565MD	IC (OP AMP X2)	
IC351			BA3129F	IC (SWITCH)	
IC380			BA3131FS	IC	
IC500			TDA7386	IC	
Q1			DTA114YK	DIGITAL TRANSISTOR	
Q2			DTA114EK	DIGITAL TRANSISTOR	
Q3,4			DTC124EK	DIGITAL TRANSISTOR	
Q5			DTA144EK	DIGITAL TRANSISTOR	
Q6			2SK536	TRANSISTOR	
Q150			2SK536	TRANSISTOR	

E : Europe K : North America M : Other Areas
W : Without Europe

K : DPX-4010 (K type)
M : DPX-4010 (M type)
H : DPX-4010/PH4

△ Indicates safety critical components.

PARTS LIST

* New parts

Parts without **Parts No.** are not supplied.

Les articles non mentionnés dans le **Parts No.** ne sont pas fournis.

Teile ohne **Parts No.** werden nicht geliefert.

MAIN PWB UNIT

Ref. No.	A d d	N e w	Parts No.	Description	Desti- nation	Ref. No.	A d d	N e w	Parts No.	Description	Desti- nation
Q151			DTC124EK	DIGITAL TRANSISTOR		C827			CK73GB1A224K	CHIP C 0.22UF K	
Q152			DTA124EK	DIGITAL TRANSISTOR		C828			CK73GB1H102K	CHIP C 1000PF K	
Q300			DTC124EK	DIGITAL TRANSISTOR		C829			CK73GB1H472K	CHIP C 4700PF K	
Q350A,B			2SC2412K	TRANSISTOR		C830			CK73GB1C683K	CHIP C 0.068UF K	
Q351			DTC343TK	DIGITAL TRANSISTOR		C831,832			CK73GB1C104K	CHIP C 0.10UF K	
Q352			2SC2412K	TRANSISTOR		C833			CK73GB1A224K	CHIP C 0.22UF K	
Q353			DTC124EK	DIGITAL TRANSISTOR		C834			CK73GB1H472K	CHIP C 4700PF K	
Q400			DTC144EK	DIGITAL TRANSISTOR		C835			CK73GB1H102K	CHIP C 1000PF K	
Q401			DTA144EK	DIGITAL TRANSISTOR		C836			CK73GB1C683K	CHIP C 0.068UF K	
Q500A,B			DTC343TK	DIGITAL TRANSISTOR		C837			C90-5327-08	CHIP-TAN 10UF 16WV	
Q501A,B			DTC343TK	DIGITAL TRANSISTOR		C850			CE04CW1A101M	ELECTRO 100UF 10WV	
Q502			DTC124EK	DIGITAL TRANSISTOR		C851			CK73GB1E473K	CHIP C 0.047UF K	
Q600			2SA1703-AN	TRANSISTOR		C852			CE04CW1A101M	ELECTRO 100UF 10WV	
Q601			2SA1037K	TRANSISTOR		C853A,B			C90-2610-05	ELECTRO 2.2UF 50WV	
Q602			2SA1703-AN	TRANSISTOR		C854A,B			CK73GB1H222K	CHIP C 2200PF K	
Q603			DTA124EK	DIGITAL TRANSISTOR		C855A,B			CC73GCH1H101J	CHIP C 100PF J	
Q604			DTC144EK	DIGITAL TRANSISTOR		C856A,B			C90-2610-05	ELECTRO 2.2UF 50WV	
Q605,606			DTC114EK	DIGITAL TRANSISTOR		C857A,B			CK73GB1H222K	CHIP C 2200PF K	
Q607,608			2SC2412K	TRANSISTOR		C890,891			CC73FCH1H220J	CHIP C 22PF J	
Q609-612			2SA1703-AN	TRANSISTOR		CN800			E40-9608-08	22P CONNECTOR	
Q613			DTB123YS	DIGITAL TRANSISTOR		CN801			E40-9675-08	20P CONNECTOR	
Q614			2SC4483(R,S,T)	TRANSISTOR		CN850			E41-0109-08	18P CONNECTOR	
Q615			2SB1565(E,F)	TRANSISTOR		CN851			E40-3300-05	3P PIN ASSY	
Q616			2SA1703-AN	TRANSISTOR		CN852			E40-9614-08	3P PIN ASSY	
Q617			2SC2412K	TRANSISTOR		L820			L33-1116-08	CHOKE COIL 47uH	
Q621,622			2SC2412K	TRANSISTOR		B	2F *		N09-4433-08	SCREW (3X8,S,BLK)	
Q624			DTC124EK	DIGITAL TRANSISTOR		JC800-803			R92-2053-05	CHIP R 0 J 1/8W	
Q625			DTC114EK	DIGITAL TRANSISTOR		R800,801			RK73GB1J102J	CHIP R 1.0K J 1/16W	
Q626			DTC124EK	DIGITAL TRANSISTOR		R802			RK73GB1J223J	CHIP R 22K J 1/16W	
Q627			DTA124EK	DIGITAL TRANSISTOR		R820			RK73GB1J100J	CHIP R 10 J 1/16W	
Q628			DTC124EK	DIGITAL TRANSISTOR		R821			RK73GB1J223J	CHIP R 22K J 1/16W	
TH500			TH104K01J	THERMISTOR 100K		R822-824			RK73GB1J102J	CHIP R 1.0K J 1/16W	
DC700			W02-3162-08	DC/DC CONVERTER (TMA787A)		R850			RK73GB1J100J	CHIP R 10 J 1/16W	
L600			W02-3177-08	CHOKE COIL		R851,852			RK73GB1J103J	CHIP R 10K J 1/16W	
TU100			W02-3181-08	FM/AM FRONT-END		R853			RK73GB1J104J	CHIP R 100K J 1/16W	
SUB PWB UNIT									RK73GB1J223J	CHIP R 22K J 1/16W	
C800			CK73GB1E473K	CHIP C 0.047UF K		R854A,B			RK73GB1J223J	CHIP R 22K J 1/16W	
C801			CE04CW1C470M	ELECTRO 47UF 16WV		R856A,B			RK73GB1J223J	CHIP R 22K J 1/16W	
C802			CK73GB1E473K	CHIP C 0.047UF K		R857A,B			RK73GB1J223J	CHIP R 22K J 1/16W	
C803			CE04CW1A101M	ELECTRO 100UF 10WV		R858A,B			RK73GB1J222J	CHIP R 2.2K J 1/16W	
C804			CE04CW1C470M	ELECTRO 47UF 16WV		R859A,B			RK73GB1J222J	CHIP R 2.2K J 1/16W	
C805			CK73GB1E473K	CHIP C 0.047UF K		R860A,B			RK73GB1J471J	CHIP R 470 J 1/16W	
C806			CE04CW1A101M	ELECTRO 100UF 10WV		R861A,B			RK73GB1J223J	CHIP R 22K J 1/16W	
C807			CE04CW1C470M	ELECTRO 47UF 16WV		R862A,B			RK73FB2A102J	CHIP R 1.0K J 1/10W	
C808			CK73GB1E473K	CHIP C 0.047UF K		R863A,B			RK73GB1J223J	CHIP R 22K J 1/16W	
C809			CE04CW1A101M	ELECTRO 100UF 10WV		R864A,B			RK73GB1J223J	CHIP R 22K J 1/16W	
C810			CK73GB1E473K	CHIP C 0.047UF K		R865A,B			RK73GB1J222J	CHIP R 2.2K J 1/16W	
C820			CE04CW1A101M	ELECTRO 100UF 10WV		R866A,B			RK73GB1J471J	CHIP R 470 J 1/16W	
C821			CK73GB1C104K	CHIP C 0.10UF K		R867A,B			RK73GB1J223J	CHIP R 22K J 1/16W	
C822			C90-2610-05	ELECTRO 2.2UF 50WV		R868A,B			RK73FB2A102J	CHIP R 1.0K J 1/10W	
C823			CK73GB1A154K	CHIP C 0.15UF K		D800			MA4082(N)-L	ZENER DIODE	
C824A,B			C90-2610-05	ELECTRO 2.2UF 50WV		D801			MA4091(N)-L	ZENER DIODE	
C825A,B			C90-2597-05	ELECTRO 10UF 16WV		D802			UDZ5.6B	ZENER DIODE	
C826			CE04CW1A101M	ELECTRO 100UF 10WV		D850-852			1SS355	DIODE	

E : Europe K : North America M : Other Areas

K : DPX-4010 (K type)

△ Indicates safety critical components.

W : Without Europe

M : DPX-4010 (M type)

H : DPX-4010/PH4

DPX-4010,4010/PH4

PARTS LIST

* New parts

Parts without **Parts No.** are not supplied.

Les articles non mentionnés dans le **Parts No.** ne sont pas fournis.

Teile ohne **Parts No.** werden nicht geliefert.

SUB PWB UNIT

Ref. No.	A d d	N e w	Parts No.	Description	Desti- nation
D890A,B			NNCD6.2F	ZENER DIODE	
D891			NNCD6.2F	ZENER DIODE	
D892A,B			NNCD6.2F	ZENER DIODE	
D893			NNCD6.2F	ZENER DIODE	
IC820			M65849BFP	IC	
IC850			BA3129F	IC (SWITCH)	
IC851			NJM4565MD	IC (OP AMP X2)	
Q800			2SB1565(E,F)	TRANSISTOR	
Q801			2SC2412K	TRANSISTOR	
Q802			2SC4483(R,S,T)	TRANSISTOR	
Q803			2SB1565(E,F)	TRANSISTOR	
Q804			2SC2412K	TRANSISTOR	
Q850			DTC124EK	DIGITAL TRANSISTOR	
Q851			DTA124EK	DIGITAL TRANSISTOR	
Q852			DTC124EK	DIGITAL TRANSISTOR	
Q853A,B			DTC343TK	DIGITAL TRANSISTOR	
Q854A,B			DTC343TK	DIGITAL TRANSISTOR	

COMB. PWB UNIT (FRONT, CONTROL)

D950-952			B30-1488-05	LED (YG)	
D954,955			B30-1488-05	LED (YG)	
D956			B30-1545-05	LED (UB)	
D957,958			B30-1488-05	LED (YG)	
D959			B30-1545-05	LED (UB)	
D990-992			B30-1488-05	LED (YG)	
C900-903			CK73FB1C475K	CHIP C 4.7UF K	
C904			CK73GB1H222K	CHIP C 2200PF K	
C905			CK73FB1C475K	CHIP C 4.7UF K	
C906			CK73GB1H222K	CHIP C 2200PF K	
C907			CK73FB1C475K	CHIP C 4.7UF K	
C950			CK73GB1H223K	CHIP C 0.022UF K	
C951,952			CK73FB1C475K	CHIP C 4.7UF K	
C980			CK73GB1E473K	CHIP C 0.047UF K	
C981			CK73FB1C474K	CHIP C 0.47UF K	
C982,983			CK73GB1C104K	CHIP C 0.10UF K	
C984,985			CK73FB1C475K	CHIP C 4.7UF K	
CN900			E40-9676-08	22P CONNECTOR	
CN990			E40-9676-08	22P CONNECTOR	
CN992			E40-9756-08	14P CONNECTOR	
CN993			E40-9588-08	6P CONNECTOR	
FPC1	3H		E39-0266-08	FLEXIBLE PRINTED WIRING BOARD	
X900			L78-0592-08	CERAMIC RESONATOR 8.38MHZ	
R900			RK73GB1J100J	CHIP R 10 J 1/16W	
R907			RK73GB1J100J	CHIP R 10 J 1/16W	
R908			RK73GB1J102J	CHIP R 1.0K J 1/16W	
R916,917			RK73GB1J104J	CHIP R 100K J 1/16W	
R918			RK73GB1J102J	CHIP R 1.0K J 1/16W	
R919			RK73GB1J224J	CHIP R 220K J 1/16W	
R928			RK73GB1J473J	CHIP R 47K J 1/16W	
R929-931			RK73GB1J101J	CHIP R 100 J 1/16W	
R932,933			RK73GB1J104J	CHIP R 100K J 1/16W	
R934			RK73GB1J473J	CHIP R 47K J 1/16W	
R950-961			RK73EB2B122J	CHIP R 1.2K J 1/8W	

Ref. No.	A d d	N e w	Parts No.	Description	Desti- nation
R962,963			RK73EB2B152J	CHIP R 1.5K J 1/8W	
R968			RK73GB1J101J	CHIP R 100 J 1/16W	
R969			RK73GB1J102J	CHIP R 1.0K J 1/16W	
R970,971			RK73GB1J101J	CHIP R 100 J 1/16W	
R972			RK73GB1J100J	CHIP R 10 J 1/16W	
R980			RK73GB1J100J	CHIP R 10 J 1/16W	
R981			RK73GB1J822J	CHIP R 8.2K J 1/16W	
R982			RK73GB1J124J	CHIP R 120K J 1/16W	
R983			RK73GB1J102J	CHIP R 1.0K J 1/16W	
R984			RK73GB1J104J	CHIP R 100K J 1/16W	
R985			RK73GB1J124J	CHIP R 120K J 1/16W	
R986,987			RK73GB1J104J	CHIP R 100K J 1/16W	
R990,991			RK73EB2B122J	CHIP R 1.2K J 1/8W	
R992,993			RK73EB2B152J	CHIP R 1.5K J 1/8W	
RN900,901			R90-0724-05	MULTI-COMP 1K X4	
RN902			RK73FB2A473J	CHIP R 47K J 1/10W	
RN903			R90-0724-05	MULTI-COMP 1K X4	
S900		*	S70-0856-08	TACT SW (SKQRAA)	
S950,951		*	S70-0879-08	TACT SW (SKQDAB)	
S952,953		*	S70-0854-08	TACT SW (WITH LED)	
S954		*	S70-0879-08	TACT SW (SKQDAB)	
S955		*	S70-0856-08	TACT SW (SKQRAA)	
S956-961		*	S70-0854-08	TACT SW (WITH LED)	
S962,963		*	S70-0879-08	TACT SW (SKQDAB)	
S964		*	S70-0854-08	TACT SW (WITH LED)	
S965-967		*	S70-0879-08	TACT SW (SKQDAB)	
S968		*	S70-0854-08	TACT SW (WITH LED)	
S969		*	S70-0879-08	TACT SW (SKQDAB)	
S990		*	S70-0854-08	TACT SW (WITH LED)	
D900-902			1SS355	DIODE	
D903			NNCD6.2F	ZENER DIODE	
D904-908			1SS355	DIODE	
D953			B30-1488-05	LED (YG)	
D960			NNCD6.2F	ZENER DIODE	
D993			B30-1541-08	LED (YG)	
IC900		*	MN101C10AAK	IC	
IC901			RS-21	IC (RIMOCN SENSOR)	
IC980		*	M61506FP	IC	
VFD900		*	CN1952M	FLUORESCENT INDICATOR TUBE	

PROCESSOR UNIT (X32-4820-01)

C1,2			CK73FB1A105K	CHIP C 1.0UF K	
C3			C92-1359-05	CHIP-TAN 10UF 16WV	
C4			C92-0566-05	CHIP-TAN 10UF 6.3WV	
C5			CC73GCH1H150J	CHIP C 15PF J	
C6			CC73GCH1H020C	CHIP C 2.0PF C	
C7			CK73GB1C104K	CHIP C 0.10UF K	
C8			CK73FB1A105K	CHIP C 1.0UF K	
C9			CC73GCH1H101J	CHIP C 100PF J	
C10			CK73GB1H472K	CHIP C 4700PF K	
C11			CK73GB1H682K	CHIP C 6800PF K	
C12			CK73GB1H222K	CHIP C 2200PF K	
C13			CK73GB1C273K	CHIP C 0.027UF K	
C14			CK73GB1H472K	CHIP C 4700PF K	
C15			CK73GB1C473K	CHIP C 0.047UF K	

E : Europe K : North America M : Other Areas

K : DPX-4010 (K type)

△ Indicates safety critical components.

W : Without Europe

M : DPX-4010 (M type)

H : DPX-4010/PH4

PARTS LIST

* New parts

Parts without **Parts No.** are not supplied.

Les articles non mentionnés dans le **Parts No.** ne sont pas fournis.

Teile ohne **Parts No.** werden nicht geliefert.

PROCESSOR UNIT (X32-4820-01)

Ref. No.	A d d	N e w	Parts No.	Description	Desti- nation	Ref. No.	A d d	N e w	Parts No.	Description	Desti- nation
C16			CC73GCH1H820J	CHIP C 82PF J		R34			RK73FB2A683J	CHIP R 68K J 1/10W	
C17			CK73GB1H472K	CHIP C 4700PF K		R35			RK73FB2A104J	CHIP R 100K J 1/10W	
C18			CK73GB1H331K	CHIP C 330PF K		R36			RK73FB2A151J	CHIP R 150 J 1/10W	
C19,20			CK73GB1C104K	CHIP C 0.10UF K		R37			RK73FB2A471J	CHIP R 470 J 1/10W	
C21			C92-1359-05	CHIP-TAN 10UF 16WV		R38			RK73FB2A224J	CHIP R 220K J 1/10W	
C22			CK73GB1C104K	CHIP C 0.10UF K		R44			RK73FB2A512J	CHIP R 5.1K J 1/10W	
C23			CK73GB1H102K	CHIP C 1000PF K		R45			RK73FB2A103J	CHIP R 10K J 1/10W	
C24			CK73GB1E223K	CHIP C 0.022UF K		R46			RK73FB2A102J	CHIP R 1.0K J 1/10W	
C25			CK73GB1E123K	CHIP C 0.012UF K		R47			RK73FB2A103J	CHIP R 10K J 1/10W	
C26			CK73FB1A105K	CHIP C 1.0UF K		R49			RK73FB2A472J	CHIP R 4.7K J 1/10W	
C28			CK73FB1A105K	CHIP C 1.0UF K		R50			RK73FB2A102J	CHIP R 1.0K J 1/10W	
C29			CK73GB1C104K	CHIP C 0.10UF K		R52			RK73FB2A104J	CHIP R 100K J 1/10W	
C31,32			CK73GB1H103K	CHIP C 0.010UF K		R54			RK73FB2A104J	CHIP R 100K J 1/10W	
C33			CK73GB1C104K	CHIP C 0.10UF K		R71			RK73FB2A103J	CHIP R 10K J 1/10W	
C34			CK73EB1A335K	CHIP C 3.3UF K		R72			RK73FB2A102J	CHIP R 1.0K J 1/10W	
C35			CK73GB1C104K	CHIP C 0.10UF K		R73			RK73FB2A473J	CHIP R 47K J 1/10W	
C41			CK73EB1C225K	CHIP C 2.2UF K		R74			RK73FB2A103J	CHIP R 10K J 1/10W	
C43			CK73GB1E123K	CHIP C 0.012UF K		R75			RK73FB2A333J	CHIP R 33K J 1/10W	
C44			CK73GB1C104K	CHIP C 0.10UF K		R76			RK73FB2A622J	CHIP R 6.2K J 1/10W	
C45			CK73GB1E123K	CHIP C 0.012UF K		R77			RK73FB2A563J	CHIP R 56K J 1/10W	
C46			CK73GB1C473K	CHIP C 0.047UF K		R78			RK73FB2A243J	CHIP R 24K J 1/10W	
C51			CK73EB1A335K	CHIP C 3.3UF K		R79			RK73FB2A912J	CHIP R 9.1K J 1/10W	
C55			CK73GB1C104K	CHIP C 0.10UF K		R80			RK73FB2A202J	CHIP R 2.0K J 1/10W	
C63			C92-1359-05	CHIP-TAN 10UF 16WV		R81			RK73FB2A333J	CHIP R 33K J 1/10W	
C67,68			CK73FB1A105K	CHIP C 1.0UF K		R82			RK73FB2A103J	CHIP R 10K J 1/10W	
C71,72			CK73GB1H471K	CHIP C 470PF K		R83			RK73FB2A102J	CHIP R 1.0K J 1/10W	
C77,78			CC73GCH1H680J	CHIP C 68PF J		R101,102			RK73FB2A333J	CHIP R 3.3K J 1/10W	
C79,80			C93-1044-05	CERAMIC 2200PF K		R103,104			RK73FB2A562J	CHIP R 5.6K J 1/10W	
C85			CK73GB1C104K	CHIP C 0.10UF K		R107,108			RK73FB2A331J	CHIP R 330 J 1/10W	
C88			CK73GB1C104K	CHIP C 0.10UF K		R117,118			RK73FB2A203J	CHIP R 20K J 1/10W	
CN1			E40-9536-05	FLAT CABLE CONNECTOR		R121,122			RK73FB2A203J	CHIP R 20K J 1/10W	
CN2			E40-9339-05	FLAT CABLE CONNECTOR		R125,126			RK73FB2A203J	CHIP R 20K J 1/10W	
L1			L40-1001-78	SMALL FIXED INDUCTOR (10UH)		R202			RK73FB2A102J	CHIP R 1.0K J 1/10W	
L2			L92-0308-05	FERRITE CORE		R214			RK73FB2A104J	CHIP R 100K J 1/10W	
X1			L78-0572-05	RESONATOR (16.93MHZ)		R218			RK73FB2A473J	CHIP R 47K J 1/10W	
CP1-3			R90-1019-05	MULTI-COMP 100 X2		R221-224			RK73FB2A912J	CHIP R 9.1K J 1/10W	
R1,2			RK73FB2A333J	CHIP R 33K J 1/10W		R225,226			RK73FB2A433J	CHIP R 43K J 1/10W	
R3			RK73FB2A683J	CHIP R 68K J 1/10W		R227			RK73FB2A102J	CHIP R 1.0K J 1/10W	
R5			RK73FB2A910J	CHIP R 91 J 1/10W		R228			RK73FB2A512J	CHIP R 5.1K J 1/10W	
R6			RK73FB2A683J	CHIP R 68K J 1/10W		R229			RK73FB2A102J	CHIP R 1.0K J 1/10W	
R8			RK73EB2B4R7J	CHIP R 4.7 J 1/8W		R230			RK73FB2A512J	CHIP R 5.1K J 1/10W	
R9			RK73EB2B100J	CHIP R 10 J 1/8W		R231			RK73FB2A432J	CHIP R 4.3K J 1/10W	
R10,11			RK73FB2A822J	CHIP R 8.2K J 1/10W		R232			RK73FB2A133J	CHIP R 13K J 1/10W	
R12			RK73FB2A472J	CHIP R 4.7K J 1/10W		W7-9			R92-2052-05	CHIP R 0 J 1/10W	
R13			RK73FB2A683J	CHIP R 68K J 1/10W		W10			R92-2053-05	CHIP R 0 J 1/8W	
R14,15			RK73FB2A824J	CHIP R 820K J 1/10W		W15,16			R92-2052-05	CHIP R 0 J 1/10W	
R16			RK73FB2A223J	CHIP R 22K J 1/10W		S1,2			S68-0838-05	PUSH SWITCH	
R17			RK73FB2A133J	CHIP R 13K J 1/10W		S3			S68-0823-05	PUSH SWITCH	
R18			RK73FB2A392J	CHIP R 3.9K J 1/10W		D1,2			DAN202U	DIODE	
R19			RK73FB2A432J	CHIP R 4.3K J 1/10W		D3			DA204K	DIODE	
R20			RK73FB2A104J	CHIP R 100K J 1/10W		D4			DAN202U	DIODE	
R21			RK73FB2A224J	CHIP R 220K J 1/10W		IC1			AN8806SB	ANALOGUE IC	
R22,23			RK73FB2A333J	CHIP R 33K J 1/10W		IC2			MN662774KE0	MOS-IC	
R32			RK73FB2A104J	CHIP R 100K J 1/10W							

E : Europe K : North America M : Other Areas

W : Without Europe

K : DPX-4010 (K type)

M : DPX-4010 (M type)

H : DPX-4010/PH4

△ Indicates safety critical components.

DPX-4010,4010/PH4

PARTS LIST

* New parts

Parts without **Parts No.** are not supplied.

Les articles non mentionnés dans le **Parts No.** ne sont pas fournis.

Teile ohne **Parts No.** werden nicht geliefert.

PROCESSOR UNIT (X32-4820-01)

Ref. No.	A d d	N e w	Parts No.	Description	Desti- nation
IC4			BA5917AFP	ANALOGUE IC	
IC5			TA78L05F	IC (VOLTAGE REGULATOR/ +5V)	
IC6			NJM4565MD	IC (OP AMP X2)	
IC10			BU4551BFV	ANALOGUE IC	
Q1			2SB1188	TRANSISTOR	
Q2			DTC124EUA	DIGITAL TRANSISTOR	
Q3,4			2SA1362(Y)	TRANSISTOR	
Q5			DTC124EUA	DIGITAL TRANSISTOR	
Q9-12			DTC114YUA	DIGITAL TRANSISTOR	
CD MECHANISM ASSY (X92-3900-01)					
401	2C		A10-4482-01	CHASSIS	
402	1D		A10-4225-33	CHASSIS CALKING ASSY	
403	2D		A11-0915-43	SUB CHASSIS CALKING ASSY	
405	2C		D10-3082-13	ARM	
405A	2C		D10-4038-23	ARM ASSY	
406	2C		D10-4306-14	ARM ASSY	
407	2C		D10-4305-14	ARM ASSY	
408	3C		D10-3087-44	ARM ASSY	
409	3D		D10-3092-03	SLIDER	
410	3D		D10-3093-04	SLIDER ASSY	
411	2D		D10-3095-04	SLIDER ASSY	
412	2D		D10-3096-04	SLIDER ASSY	
413	1C		D10-3099-24	SLIDER ASSY	
414	1C		D10-3100-04	SLIDER ASSY	
415	2C		D10-4123-24	LEVER ASSY	
416	1D		D10-4004-04	LEVER ASSY	
417	1D		D10-4006-04	LEVER	
418	1C		D10-4007-04	LEVER	
419	2D		D10-4008-14	LEVER	
420	2C		D10-4009-23	ARM	
421	3C		D10-4010-04	LEVER	
422	3C		D10-4307-04	LEVER ASSY	
424	3D		D10-4050-04	ARM	
427	3D		D13-1442-03	RACK (GEAR)	
429	3D		D13-1231-04	GEAR	
430	3C		D13-1240-04	GEAR	
431	3D		D13-1233-04	GEAR	
432	3D		D13-1234-14	GEAR ASSY	
433	3C		D13-1441-03	GEAR	
434	3D		D13-1232-04	GEAR	
435	3D		D13-1241-04	GEAR	
436	3D		D13-1242-04	GEAR	
437	1D		D13-1243-04	GEAR	
438	1D		D13-1244-04	GEAR	
439	1D		D13-1245-14	GEAR	
440	2C		D13-1246-04	GEAR	
441	2D		D13-1247-04	GEAR	
443	2D		D13-1249-04	GEAR ASSY	
444	2D		D13-2090-04	GEAR ASSY	
445	1D		D14-0668-04	ROLLER	
446	1C		D14-0670-04	ROLLER	
447	3D		D14-0674-04	ROLLER	
449	3C		D21-2228-14	SHAFT	
450	1C		D21-2229-04	SHAFT	

Ref. No.	A d d	N e w	Parts No.	Description	Desti- nation
451	1C		D23-0925-24	RETAINER	
452	2C		D32-0614-04	STOPPER	
453	1D		D39-0223-05	DAMPER	
454	2D		D39-0224-05	DAMPER	
455	3D		F09-1246-04	SHEET	
458	3D		F09-1266-14	SHEET	
460	2C		G01-2770-04	EXTENSION SPRING	
461	3C		G01-2771-04	EXTENSION SPRING	
462	3C		G01-2772-24	EXTENSION SPRING	
463	3C		G01-2773-14	EXTENSION SPRING	
464	3C		G01-2774-34	EXTENSION SPRING	
465	1D		G01-2775-04	TORSION COIL SPRING	
466	1D		G01-2776-14	TORSION COIL SPRING	
467	3D		G01-2777-24	TORSION COIL SPRING	
469	2C		G01-2844-04	EXTENSION SPRING	
470	2C		G02-1231-04	FLAT SPRING	
471	2D		G02-1232-24	FLAT SPRING	
472	2C		G02-1241-24	FLAT SPRING	
475	2C		J11-0613-13	CLAMPER	
476	3C		J19-4678-13	HOLDER	
477	2D		J19-4679-24	HOLDER	
478	3D		J21-7684-13	MOUNTING HARDWARE	
479	2C		J21-7686-13	MOUNTING HARDWARE	
480	1D		J21-7690-03	MOUNTING HARDWARE	
482	3C		J84-0107-05	FLEXIBLE PRINTED WIRING BOARD	
483	1C		J90-0757-22	GUIDE	
A	2C		N09-4249-05	MACHINE SCREW (M1.7X2.5,LOCK)	
B	1D		N09-4172-05	TAPPING SCREW (2X3.5,C)	
C	2D		N09-4202-05	STEPPED SCREW	
D	2C		N38-2020-46	PAN HEAD MACHIN SCREW	
E	3C		N09-4294-05	TAPTITE SCREW (BIND P TAPTIT)	
F	3D		N19-2023-04	FLAT WASHER	
G	2C		N19-2058-04	FLAT WASHER	
H	3C		N19-2093-04	FLAT WASHER	
J	2C		N39-2020-46	PAN HEAD MACHIN SCREW	
DM1	3D		T42-1026-04	DC MOTOR ASSY (SP)	
DM2	3D		T42-1028-04	DC MOTOR ASSY (SLD)	
DPU1	2D		T25-0215-05	OPTICAL PICKUP HEAD	
CASSETTE MECHANISM ASSY (D40-1155-08)					
1	2B		A10-4630-08	CHASSIS ASSY	
4	3B		D10-4375-08	SLIDER (MAIN PLATE)	
5	3A		D13-1494-08	GEAR (B)	
6	3A		D13-1495-08	GEAR (C)	
7	3A		D13-1496-08	GEAR (D)	
9	1B		D10-4376-08	ARM(P-G PLATE)	
10	2B		J90-0948-08	GUID	
11	2B		D15-0919-08	PULLEY (MID)	
12	2B		D13-1497-08	GEAR (P)	
15	2B		J21-9458-08	MOUNTING HARDWARE (HEAD P-AS)	
17	2B		G02-1332-08	FLAT SPRING (HEAD SP-P)	
20	2A		D13-1498-08	RACK GEAR (OP PLATE A)	
21	1A		D10-4377-08	LEVER (EJ-LEV-A)	
22	3B		D10-4378-08	LEVER (SB.PL-AS)	

E : Europe K : North America M : Other Areas
W : Without Europe

K : DPX-4010 (K type)
M : DPX-4010 (M type)
H : DPX-4010/PH4

△ Indicates safety critical components.

PARTS LIST

* New parts

Parts without **Parts No.** are not supplied.

Les articles non mentionnes dans le **Parts No.** ne sont pas fournis.

Teile ohne **Parts No.** werden nicht geliefert.

CASSETTE MECHANISM ASSY (D40-1155-08)

Ref. No.	A d d	N e w	Parts No.	Description	Desti- nation	Ref. No.	A d d	N e w	Parts No.	Description	Desti- nation
23	2A		D10-4379-08	LEVER (OP-PL-HO)							
24	1A		D10-4380-08	LEVER (EJE-LEV-A)							
25	1A		G01-2960-08	TENSION COIL SPRING (E LEV-SP)							
26	3A		D13-1499-08	GEAR (FR)							
27	3A		D10-4381-08	ARM (FR-PLATE)							
30	2B		D10-4382-08	ARM ASSY (PINCH ROLLER F)							
31	2B		D10-4383-08	ARM ASSY (PINCH ROLLER R)							
45	2A		J11-0632-08	CLAMPER							
48	3B		D01-0613-08	FLYWHEEL ASSY							
49	3B		D16-0616-08	BELT							
52	1B		D10-4385-08	ARM (CASSETTE LIFTER B)							
53	1B		J19-4953-08	CASSETTE HOLDER							
54	1A		G11-1861-08	CUSHION							
56	1B		D10-4386-08	ARM ASSY							
57	1B		G01-2962-08	TENSION COIL SPRING							
58	1B		D10-4387-08	SLIDER							
65	2A		B09-0522-08	REEL CAP							
66	2A		G01-2963-08	COMPRESSION SPRING							
67	2A		D03-0314-08	REEL GEAR ASSY							
90	3A	*	J26-4042-08	PC BORD ASSY							
94	3A		T95-0245-08	PHOTO COUPLER							
A	3A		N09-4324-08	SCREW(2X2.5)							
B	2A		N19-2136-08	FLAT WASHER (1.55X35)							
C	2B		N09-4325-08	SCREW (2X13ADS)							
D	2A		N09-4326-08	SCREW (2X3)							
E	2A		N09-4058-08	SEMS (2X3AMS)							
F	2B		N19-2038-08	FLAT WASHER (0.85X2.8)							
G	2B		N19-2136-08	FLAT WASHER (1.55X3)							
H	2B		N19-2137-08	FLAT WASHER (2.1X3.5)							
J	3B		N19-2138-08	FLAT WASHER (2.1X3.5)							
K	3B		N09-4327-08	SCREW							
M	3B		N09-4329-08	SCREW (3X3.5)							
N	1B		N19-2139-08	FLAT WASHER (2.1X4.0)							
CM1	1A		T42-1002-08	MOTOR ASSY (MAIN)							
CM2	1A		T42-1001-08	MOTOR ASSY (SUB A)							
HD1	2B	*	T31-0231-08	PLAYBACK HEAD							

E : Europe K : North America M : Other Areas
W : Without Europe

K : DPX-4010 (K type)
M : DPX-4010 (M type)
H : DPX-4010/PH4

△ Indicates safety critical components.

DPX-4010,4010/PH4

SPECIFICATIONS

Specifications		DPX-4010 K type	DPX-4010 M type, DPX-4010/PH4
FM	Frequency Range (Frequency Step)	87.9MHz~107.9MHz (200kHz)	87.5MHz~108.0MHz (50kHz) 87.9MHz~107.9MHz (200kHz)
	Channel Space Selection	—	50kHz/200kHz
	Usable Sensitivity S/N : 30dB	9.3dBf (0.8μv/75Ω)	9.3dBf (0.8μv/75Ω)
	Quieting Sensitivity S/N : 50dB	15.2dBf (1.6μv/75Ω)	15.2dBf (1.6μv/75Ω)
	Frequency Response (±3.0dB)	30Hz~15kHz	30Hz~15kHz
	S/N (dB)	70dB (MONO)	70dB (MONO)
	Selectivity	≥80dB (±400kHz)	≥80dB (±400kHz)
	Stereo Separation	40dB (1kHz)	40dB (1kHz)
AM	Frequency Range (Frequency Step)	530kHz~1700kHz (10kHz)	531kHz~1611kHz (9kHz) 530kHz~1700kHz (10kHz)
	Channel Space Selection	—	9kHz/10kHz
	Usable Sensitivity S/N : 20dB	28dBμ (25μv)	28dBμ (25μv)
CASSETTE	Tape Speed	4.76cm/sec.	4.76cm/sec.
	Wow & Flutter	0.08% (WRMS)	0.08% (WRMS)
	Frequency Response (±3.0dB)	25~22kHz (70μs)	25~22kHz (70μs)
	Stereo Separation	40 (1kHz)	40 (1kHz)
	S/N Ratio Dolby NR off Dolby BNR on	60dB (BNR off) 68dB	60dB (BNR off) 68dB
CD	Laser Diode	GaAlAs (λ = 780nm)	GaAlAs (λ = 780nm)
	Digital Filter (D/A)	8 Times Over Sampling	8 Time Over Sampling
	D/A Converter	1 Bit	1 Bit
	Spindle Speed	500~200rpm (CLV)	500~200rpm (CLV)
	Wow & Flutter	Below Measurable Limit	Below Measurable Limit
	Frequency Response	10Hz~20kHz (±1dB)	10Hz~20kHz (±1dB)
	Total Harmonic Distortion	0.01% (1kHz)	0.01% (1kHz)
	S/N Ratio	93dB (1kHz)	93dB (1kHz)
	Dynamic Range	93dB	93dB
	Channel Separation	85dB	85dB
AMP	Maximum Power	45w x 4	45w x 4
	Full Bandwidth Power	22w x 4 (at less than 1% THD)	22w x 4 (at less than 1% THD)
Preout Level		1500mv/10kΩ	1500mv/10kΩ
Preout Impedance		≤600Ω	≤600Ω
GENERAL	Operating Voltage	14.4v (11v~16v)	14.4v (11v~16v)
	Current Consumption	10A	10A
	Installation Size (W) (H) (D)	178 (mm) 7 (inch)	178 (mm) 7 (inch)
		100 (mm) 3-15/16 (inch)	100 (mm) 3-15/16 (inch)
		155 (mm) 6-1/8 (inch)	155 (mm) 6-1/8 (inch)
Weight	2.7kg (5.9 lbs)	2.7kg	

KENWOOD follows a policy of continuous advancements in development. For this reason specifications may be changed without notice.

KENWOOD CORPORATION

14-6, Dogenzaka 1-chome, Shibuya-ku, Tokyo 150-8501 Japan

KENWOOD SERVICE CORPORATION
P.O. BOX 22745, 2201 East Dominguez Street, Long Beach, CA90801-5745, U.S.A.

KENWOOD ELECTRONICS CANADA INC.
6070 Kestrel Road, Mississauga, Ontario, Canada L5T 1S8

KENWOOD ELECTRONICS LATIN AMERICA S.A.
P.O. BOX 55-2791, Piso 6, Plaza Chase, Cl. 47 y, Aquilino de la Guardia, Panama, Republic of Panama

KENWOOD ELECTRONICS BRASIL LTDA.
Av. Moema, 170-17, Andar-Cobertura "B", Ed. Maximum Service Center, 04077-020 Moema, São Paulo-SP-Brasil

KENWOOD ELECTRONICS UK LIMITED
Kenwood House, Dwight Road, Watford, Herts, WD1 8EB United Kingdom

KENWOOD ELECTRONICS DEUTSCHLAND GMBH
Rembrücker-Str. 15, 63150 Heusenstamm, Germany

KENWOOD ELECTRONICS FRANCE S.A.
13, Boulevard Ney, 75018 Paris, France

KENWOOD ELECTRONICS BELGIUM N.V.
Mechelsesteenweg 418, B-1930 Zaventem, Belgium

KENWOOD ELECTRONICS ITALIA S.p.A.
Via G. Sirtori 7/9, 20129 Milano, Italy

KENWOOD IBÉRICA S.A.
Bolivia, 239-08020 Barcelona, Spain

KENWOOD ELECTRONICS AUSTRALIA PTY. LTD. (A.C.N. 001 499 074)
16 Giffnock Avenue, North Ryde, N.S.W. 2113, Australia

KENWOOD ELECTRONICS (HONG KONG) LTD.
Unit 3712-3724, Level 37, Tower 1, Metroplaza, 223 Hing Fong Road, Kwai Fong, N.T., Hong Kong

KENWOOD ELECTRONICS GULF FZE
P.O. Box 61318, Jebel Ali, Dubai, U.A.E.

KENWOOD ELECTRONICS (THAILAND) CO., LTD.
2019 New Pechburi Road, Bangkapi, Huaykwang, Bangkok, 10320 Thailand

KENWOOD ELECTRONICS SINGAPORE PTE. LTD.
1 Genting Lane #07-00, Kenwood Building, Singapore, 349544

KENWOOD ELECTRONICS (MALAYSIA) SDN BHD
#4.01 Level 4, Wisma Academy Lot 4A, Jalan 19/1, 46300 Petaling Jaya, Selangor Darul Ehsan, Malaysia